

Email: support@turboant.com
Website: www.turboant.com
Made in China





Folding Electric Scooter

M10 Lite

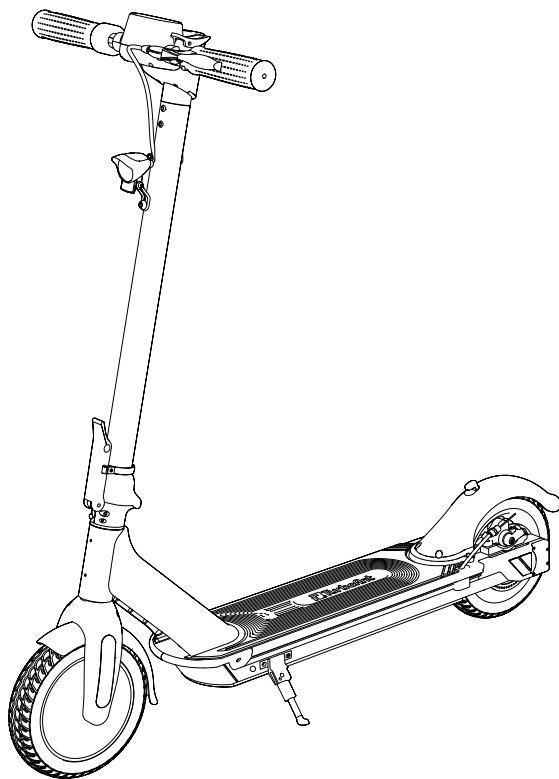

User Manual

Thank you for purchasing this product. To avoid injury to the user and others, be sure to observe the following safety instructions and guidelines. Keep this information for future reference.

Introduction



Featuring 8.5" tubed pneumatic tires, this scooter gives you a smooth riding experience. Its powerful 350 watt motor and 36 V battery enable a speed of up to 16 mph with a range of up to 15.5 miles. The reinforced frame reliably supports a body weight of up to 220 lb.







Important Safety Instructions and Guidelines

Safety Checks

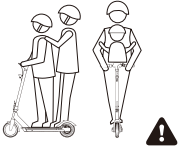
- Ensure the wiring and cables around the handlebar are not twisted, and that the throttle is on the right side while riding the electric scooter.
- Make sure that no parts are damaged or have been modified.
- Make sure that the stem has been secured properly.
- Make sure that Hall cable (black) and brake cable (red) under the brake lever are connected correctly and the brakes operate properly.
- Make sure that the tires are fully inflated.
- Make sure the battery is fully charged (the indicator light turns green).
- Test whether the scooter can be turned on/off.
- Make sure that the front and rear lights function properly in the dark.
- Children under 14 years old should be supervised by an adult.

Safety Guidelines

	<p>WARNING! RISK OF BATTERY EXPLOSION!</p> <p>Do not use the battery if it is damaged or has been modified. Do not expose to heat exceeding 95 °F (35 °C). Only use the original charging adapter.</p>
	<p>Wear protective gear such as a helmet.</p>
	<p>Do not ride the scooter in wet conditions.</p>

	<p>The scooter is only suitable for riding by a single person.</p>
	<p>The maximum load is 220 lb (100 kg).</p>
	<p>Do not ride under the influence of drugs or alcohol.</p>
	<p>Do not use a cell phone or listen to music when riding the e-scooter.</p>
	<p>Check your local traffic regulations whether riding an e-scooter in traffic is legal or not in your area.</p>
	<p>Turn on the lights in the dark.</p>

Package Contents

2 x M2.5 Allen Wrenches
 1 x M4.0 Allen Wrench
 5 x M6*10 Screws (including 1 spare screw)
 4 x M4*10 Screws
 4 x Mudguard Plugs
 1 x Charging Adapter
 1 x Valve Adapter
 1 x User Manual

Technical Specifications

Product Information	Unfolded Size	44.49 x 19.69 x 45.87 in (1130 x 500 x 1165 mm)
	Folded Size	44.49 x 19.69 x 20.48 in (1130 x 500 x 520 mm)
	Ground Clearance	3.15 in (80 mm)
	Product Weight	30.86 lb (14 kg)
	Adapter Input Voltage	100-240 V AC, 50/60 Hz
Drive System	Motor	36 V, 350 W
	Tire (Front & Rear)	8.5-inch, tubed pneumatic tires
	Max Speed	16 mph (25 km/h)
	Range	15.5 miles (25 km)
	Max Climbing Capability	15%
	Load	44-220 lb (20-100 kg)
Functions	Foldable Stem	Yes
	Battery Pack	Non-detachable
	Brake System	Electric brake and rear disc brake
	Speed	2 settings (linear adjustment)
	Illumination	LED headlight and taillight
	Warning Function	Bell
	IP Rating	IP54
Operating Conditions	Operating Temperature	32 to 113 °F (0 to 45 °C)
	Storage Temperature	-4 to 113 °F (-20 to 45 °C)
Charger	Input	100-240 V AC, 50/60 Hz
	Output	42 V DC, 1.5 A

Notes

1. Max speed values stated in the user manual depend on the road conditions and the load. Values stated on the rating label are related to average conditions.
2. Mileage is tested under the following conditions: the scooter is driven with the second speed level, 41.8 V full power battery, a load of 165 lb (75 kg), temperature of 77 °F (25 °C),

humidity of 70%, gentle breeze, 40 psi (276 kPa) in hot weather and 45 psi (310 kPa) in cold seasons, and flat, dry road conditions. Actual results may vary. If the load exceeds 220 lb (100 kg), the mileage and speed may be decreased, which can affect the riding experience.

3. Please ride safely within the maximum speed limit set by local traffic officials. Everyone should strictly abide by all traffic rules and regulations.

Battery Specifications

Type	Li-ion
Charging Time	4-5 hours
Voltage	36 V
Capacity	6.6 Ah, 238 Wh
Operating Temperature	32 to 113 °F (0 to 45 °C)
Charging Temperature	32 to 113 °F (0 to 45 °C)
Max Charging Voltage/Current	42 V, 1.5 A
Storage Temperature	-4 to 113 °F (-20 to 45 °C)
Storage Time	3 months (after a full charge)

Product Overview

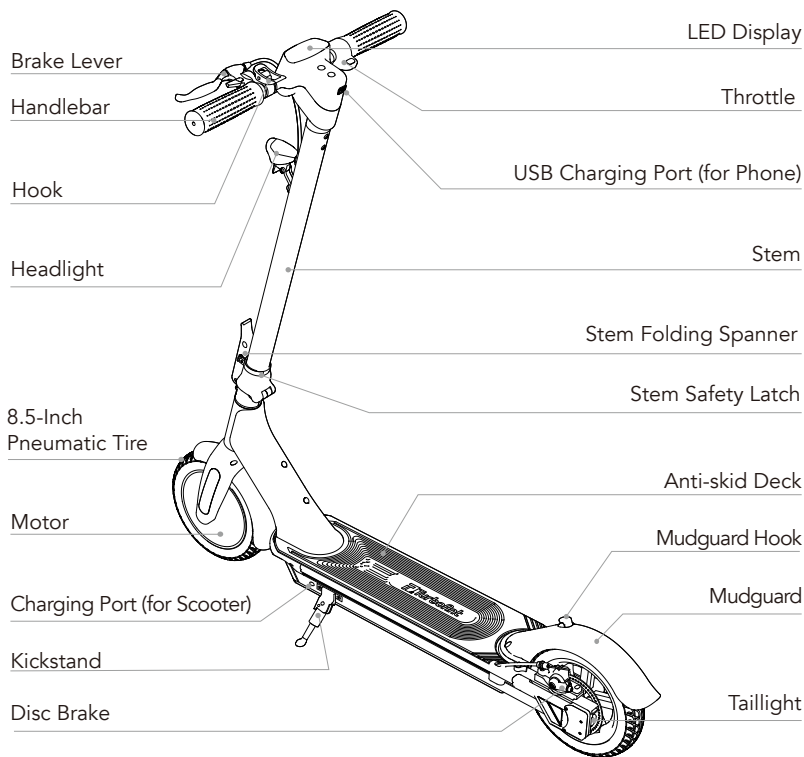

Controls Overview

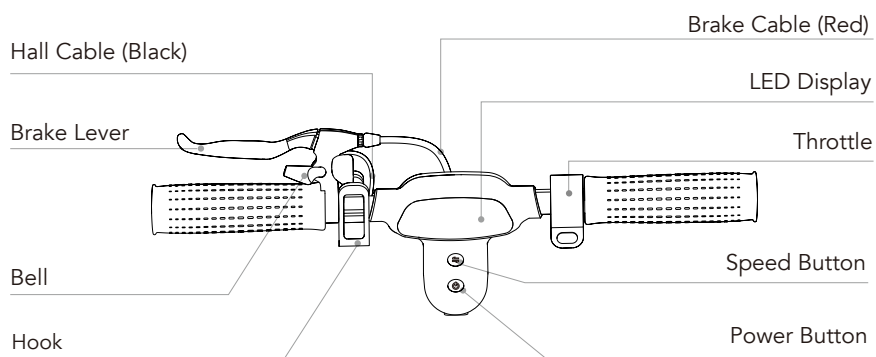

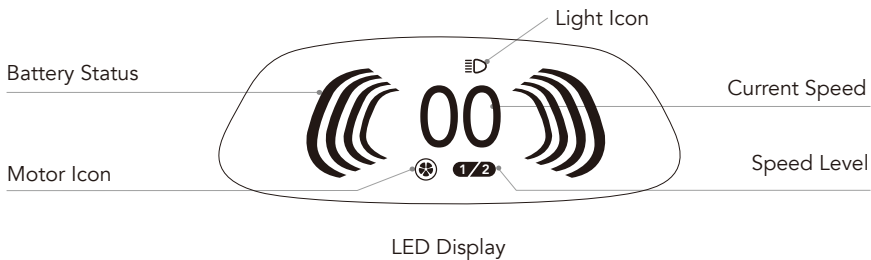

Note: If there is no operation within 10 minutes, the scooter will automatically turn off with a "beep" sound.

Controls Description

Control	Operation	
Power On/Off	Press and hold on the power button for 1 second or longer to turn on/off the scooter.	
Throttle	Press down the throttle to accelerate.	
Brake	Squeeze the brake lever to stop the scooter. When the brake lever is fully depressed, the scooter will come to a complete stop. After that, it will have to be manually started (see the General Troubleshooting and Solution Guide section).	
Speed Level	Press the speed button to adjust the speed level.	Level 1: The display shows "1"
		Level 2: The display shows "2"
Headlight	Short press the power button while the scooter is on to turn on/off the headlight.	
Cruise Mode	Maintain a constant speed that you desire (must be at least 3.7 mph or 6 km/h to activate cruise mode). Then, hold the throttle in the same position for six seconds to enable cruise control. Exit cruise mode by using either the throttle, the brake lever, or the speed button.	

Operating Instructions

Assembly

Tools needed

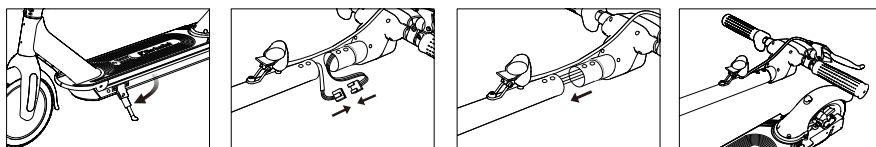
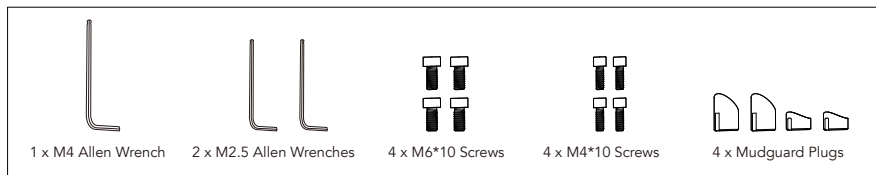

- Open the kickstand and keep the e-scooter steady on the ground.
- Connect the head wire and stem wire.
- Install the scooter head onto the stem and then fold the stem.

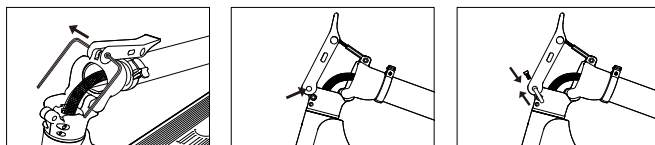

- Take off the folding spanner screw with the M2.5 Allen wrenches.
- Align the screw holes. Insert the folding spanner screw back and tighten with the M2.5 Allen wrenches.

*Use one wrench to stabilize one side and tighten/unscrew with another wrench on another side.

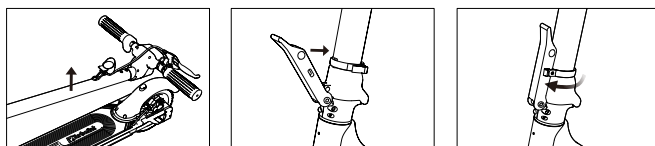

- Lift the stem and push in the folding spanner until a "click".
- Turn the stem safety latch inward to secure the folding spanner.

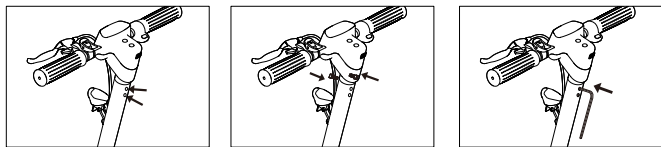

- Adjust the scooter head and align the screw holes.
- Secure the head by installing and tightening the M6x10 screws.



- Secure the mudguard by installing and tightening the M4x10 screws.
- Cover the screws with the mudguard plugs. Make sure to align the mudguard plugs' opening with the raised part next to each screw and push in to secure the plugs (use the shorter plugs for the front screws and longer plugs for the side screws).

Stem Folding

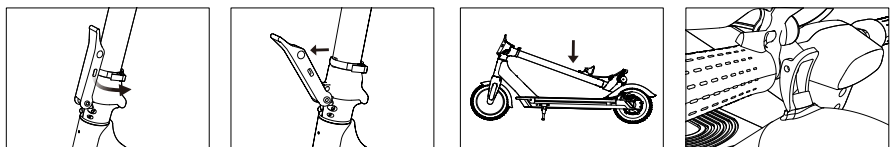

- Turn the stem safety latch outward.
- Pull the folding spanner outward.
- Fold the stem and secure it onto the hook.

Battery Maintenance

1. Only use the original battery pack. Misuse of other models or brands can cause safety issues.
2. Only use the original power adapter to avoid potential damage, electric shock, or fire.
3. Mishandling of used batteries can cause tremendous harm to the environment. To protect the natural environment, please follow local regulations to properly dispose of used batteries.
4. Do not place the battery in an environment where the ambient temperature is higher than 113 °F (45 °C) or lower than -4 °F (-20 °C) (e.g., do not leave the scooter or the battery pack in a car under direct sunlight for an extended time).
5. Do not leave the battery pack near a heat source, such as a stove, and do not throw the battery pack into fire. Doing so may result in overheating, explosion, or fire.
6. After every use, fully charge the battery to prolong its lifespan.
7. If the scooter is expected to be left unused for more than 30 days, please fully charge the battery and place it in a dry and cool place. Keep in mind to recharge the battery every 30 days to protect it from potential damage, which is beyond the coverage of our limited warranty. Always charge before exhausting the battery to prolong the battery's lifespan.
8. The battery pack performs better within the normal temperature range of 32 to 113 °F (0 to 45 °C), and performs worse when below 32 °F (0 °C). For instance, when the temperature is below -4 °F (-20 °C), the actual mileage will only be half or less than listed. When the temperature rises, the mileage will restore. Note: A fully charged TurboAnt Electric Scooter will last for 120-180 days.
9. The built-in intelligent chip will keep a log of its charging and discharging records. The damage caused by prolonged periods without charging is irreversible and is beyond the coverage of our limited warranty. Once the damage is done, the battery cannot be recharged.

Riding the Scooter

1. Wear protective gear such as a helmet.
2. Press and hold on the power button for 1 second or longer to turn on the scooter.
3. **Place one foot on the middle of the deck and use the other foot to build up some momentum before accelerating.**
4. Gently press down the throttle to accelerate.
5. Squeeze the brake lever to brake.

Battery Charging

Charging the Installed Battery

1. Remove the charging port cover under the deck. Make sure the charging port is dry and free of dust.
2. Connect the charging adapter.
3. The battery is fully charged when the indicator light of the charging adapter turns from red to green.
4. Close the charging port cover after charging the battery.

*The scooter cannot be turned on if it is connected to the charging cable, even if the cable is unpowered. When turning on the scooter, please completely remove the cable.

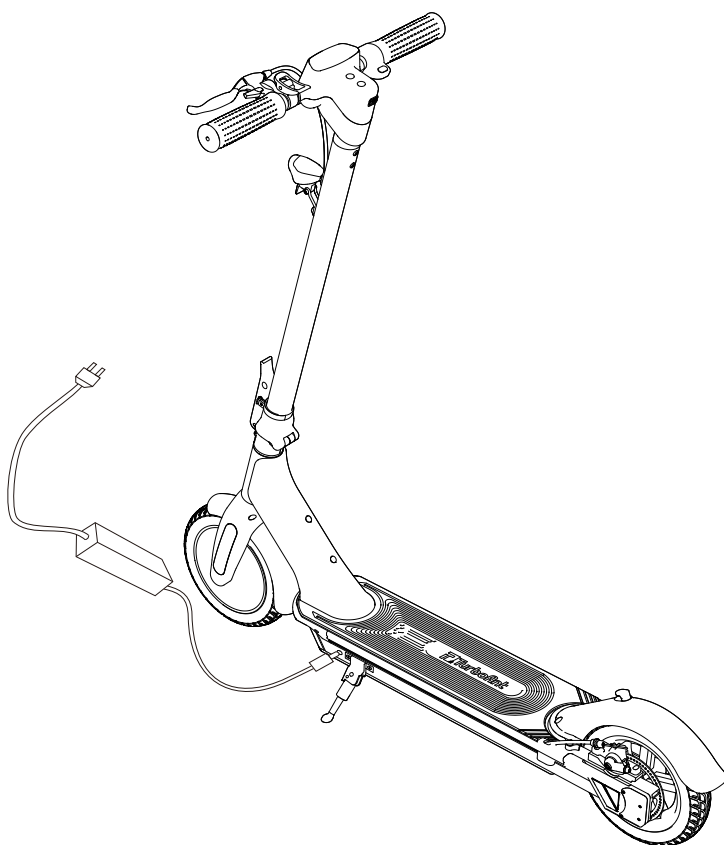

Maintenance

1. Make sure the scooter is turned off and the power adapter is disconnected.
2. Wipe clean the scooter with a damp cloth. Never use lubricating oil on the body and do not immerse it in water.

Storage

1. Fully charge the scooter before storing, and charge it at least once a month to prevent premature decay of the battery capacity.
2. Do not charge the battery if the temperature is below 32 °F (0 °C).
3. Keep the scooter in a dry, ventilated, and cool area away from direct sunlight, rain, and high humidity, and cover the scooter to protect it from dust.
4. The kickstand is designed to provide structural support, so avoid standing on the scooter while the kickstand is down, as this can cause the kickstand to crack or break.

General Troubleshooting and Solution Guide

Problem	Cause	Solution
The scooter will not turn on.	The battery has run out.	Recharge the battery.
The battery will not charge.	The charging adapter is not connected to an AC power source, or the charging adapter is damaged.	1. Connect the adapter to an AC power source. If the indicator light turns on, the adapter is in good working condition. Then, connect the adapter to the charging port on the stem or the battery (the battery can be detached for flexible charging). 2. If the indicator light does not turn on, the adapter has broken down. Replace the adapter.
	The charging adapter is not properly connected to the charging port on the stem or the battery.	Check whether the connector of the charging cable is fully inserted into the charging port on the stem or battery. If it is not fully connected, please unplug the cable and re-connect the cable to the charging port.

	The battery power is full or the battery has failed.	<p>After confirming that the charging adapter is functioning, connect the charging adapter to the AC power source and the charging port on the stem.</p> <ol style="list-style-type: none"> 1. If the indicator light turns red, then charging is normal and the battery is in good working condition. 2. If the indicator light turns green, then the battery is full or has reached its end of life. In case of failure, replace the battery.
Cruise control cannot be activated.	The current speed is below the minimum speed required for cruise control.	Cruise control can only be activated when travelling at speeds greater than 3.7 mph (6 km/h). Increase speed to enable cruise control.
	A constant speed is not maintained.	Keep a constant speed. Then, hold the throttle in the same position for 6 seconds to enable cruise control.
The stem is loose.	The screws on the stem folding spanner are loose.	Tighten the screws on the stem folding spanner.
The scooter cannot accelerate.	The scooter is set at "non-zero" start and has not been manually started.	Use your foot to give the scooter an initial momentum. When the scooter's speed reaches 1.9 mph (3 km/h), the scooter can be accelerated.
	The throttle is not released.	The throttle is equipped with an electric lock, so it needs to be completely pressed down in order to accelerate the scooter.
Normal tire pressure is between 38-40 psi (262-276 kPa) in hot weather and 40-45 psi (276-310 kPa) in cold seasons. It is necessary to periodically check the scooter to make sure all parts are in good condition, including the throttle, remaining power, tire pressure, and more.		
The tire has an air leak.	The tubed pneumatic tires may have an air leak if they have been stored for a long period. This is normal, as most air tires require pumping periodically.	Pump up the tires by taking the scooter to an automobile or motorbike repair center, or any location with a proper air compressor. Standard bicycle pumps can also be used to pump up the scooter tires.

Frequently Asked Questions (FAQs)

1. What is the optimum tire pressure when riding this scooter?

The recommended tire pressure is between 38-40 psi (262-276 kPa) in hot weather and 40-45 psi (276-310 kPa) in cold seasons. Please pump up the tires to this pressure.

2. The headlight cannot be turned on. How can I solve this problem?

If the headlight won't turn on, please verify that the scooter is turned on. When the scooter is turned on, short press the power button to see whether the headlight functions. Also, check to ensure that the lamp holder is not clogged with dust. If the lamp holder is not clogged with dust, and the lights still do not turn on, it may need to be replaced. Please contact our customer support center for help.

3. What should I do if the scooter's stem is swaying while riding the scooter?

Immediately stop riding the scooter. Verify that the screws that connect to the folding spanner and other screws on the stem are well tightened. If not, tighten the screws using the hexagonal wrench. Periodically tightening the screws on the scooter may be necessary.

4. What should I do if the brakes are not functioning properly?

- a. Turn on the scooter. Don't stand on the deck. Tilt the scooter to lift the front wheel and manually rotate the wheel. Then, press down the throttle to accelerate, and the front wheel should start to rotate. Next, hold the brake lever. If the front wheel stops rotating, the EBS (Electronic Braking System) is functioning properly. If the front wheel does not stop rotating, the Electronic Braking System may be faulty. Please contact our customer support center for help.
- b. Turn off the scooter, tilt the scooter, and manually rotate the rear wheel. Then, hold the brake lever. If the rear wheel stops rotating and there is no grinding noise, the disc brake is functioning properly. If there is a grinding noise on the brake, the disc brake may be faulty. Please contact our customer support center for help.

5. Can I replace the tires on my own?

While this is in theory possible, we highly suggest that you contact us at support@turboant.com for assistance before doing this or go to a professional bike store to have them replace the tires for you. Replacing the tires improperly or without suitable tools may result in injuries to you and/or in damage to the e-scooter, which will nullify the warranty.

6. Why does the battery life decrease over time?

The lithium-ion battery capacity will naturally degrade after 500 charge/discharge cycles. The battery performs better when within the normal temperature range of 32 to 95 °F (0 to 35 °C) and performs worse when below 32 °F (0 °C). For instance, when the temperature is below -4 °F (-20 °C), the actual mileage will only be half or less than listed.

7. When I press down the throttle, why doesn't the motor function properly?

It could be that there is a Hall wire malfunction with the Electronic Braking System. Please check to see if the wire terminals of the brake lever and the panel are loose, and whether the brake lever has been damaged.

8. What are the affecting factors of the maximum range?

The max listed mileage is 15.5 miles, which is measured under the following conditions: the scooter is ridden with the second speed level, 41.8 V full power battery, a load of 165 lb (75 kg), temperature of 77 °F (25 °C), humidity of 70%, gentle wind, tire pressure of 38-40 psi (262-276 kPa) in hot weather and 40-45 psi (276-310 kPa) in cold seasons, and flat, dry road conditions. Actual mileage may depend on a variety of factors including battery status, tire pressure, load, temperature, wind speed, road conditions, riding habits, and more. Please note that the tire is a type of tubed pneumatic tire, so fully inflating the tires can help extend your mileage.

Environmental Protection

Waste electrical products should not be disposed of with household waste. Please recycle where facilities exist. Check with your local authority or retailer for recycling advice.



<div>Claybox</div> <div>深圳市德瓴科技有限公司</div>		料号	DLTUL900ABUS
		品名	TurboAnt_M10 Lite滑板车 说明书
		材质	120g铜版纸
		工艺	单黑+骑马订+封面过哑膜
		尺寸	148*210 mm
		公差	±1 mm

注:此页不印刷