

尺寸:181.5mmX93.5mm (3折页)

成品:60.5mmX93.5mm

正面

USER INSTRUCTION Mini WiFi LED Controller



I .Product Parameter:

Category	LED Controller
Domination Principle	WiFi
APP	FVTLED
Operation Platform	Android 7.0 or IOS 12.3 or later
Language	Chinese (Simplified), Japanese, German, Chinese (Traditional-Taiwan), Spanish, English, Italian, French, Czech, Korean (North Korea), Portuguese, Russian, Hindi (India), Polish (Poland)
Channels	Single
Input Voltage	DC(12-24V)
Max Output Power	96W
Dimension(L*B*H)	53MM*24MM*11MM
Working Temperature	-20--+55°C
Control Distance	Visible distance 30M
Certification	CE, RoHS, FCC

-1-

II .Wire Connection

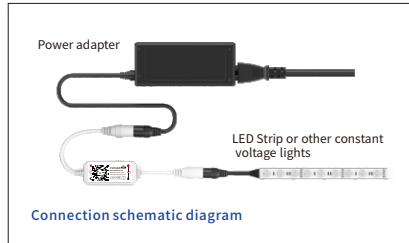

The connection between the controller and the power supply



Controller and device connection

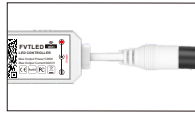

Notice:

It is necessary to ensure that the red arrow of the controller corresponds to the black arrow of the device end, otherwise the device will have a short circuit.

-2-

Important Notice:

If you need to make DIY modification to the device, please contact our customer service and operate under their guidance. Precautions: please follow the diagram instruction when doing DIY modifications.

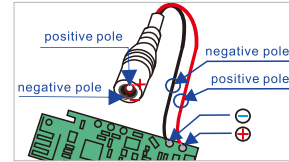

-3-

背面

IV Download FVTLED APP

Download " FVTLED " APP from App store and Google Play Store, or scan the QR code.



FVTLED APP

FAQ

Scan the " Instruction " QR code to read the electronic manual Or enter the APP FAQ to learn more .



Single

-4-

V. How to connect the controller to Wi-Fi network?

1) Register/Login your FVTLED account.

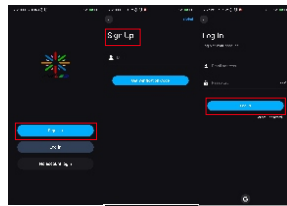

2) Open your phone Bluetooth, turn on the device.

3) Enter " FVTLED " app, tap "Add Device" or click "+" to add the device. Then select your Wi-Fi network(Only works with 2.4Ghz network), enter the password .

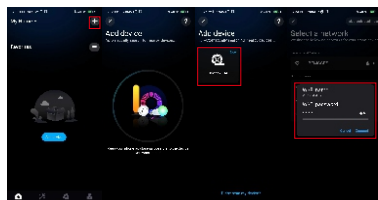

-5-

4) The device name can be modified and select the room after successfully connecting to Wi-Fi network.

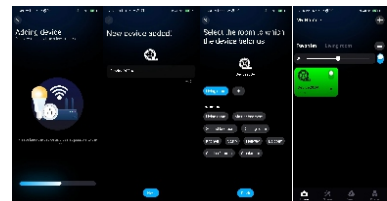

VI. How to reset the factory setting?

1) Before resetting : please ensure the device is powered off;



2)Start resetting : Turn on the light , then turn off the light , keep the light off for 5 seconds(repeat this operation 3 times);



3)Reset successful: the light will flash for a few seconds.

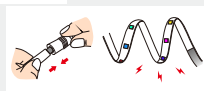

-6-