

此页不印刷（本文件共44页）

SIZE:105mm X 155mm

材质: 封面铜版纸 内页: 书纸

工艺: 封面过亚膜

注意：不要随便删减空白页  
（特别是封面内页不能出现印刷内容）

# Hunting Camera Manual

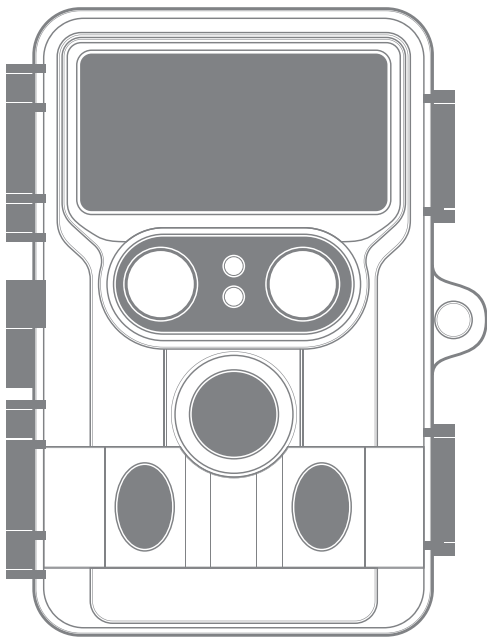



# Contents

English.....	01-34
--------------	-------



**EN**

(01~34)

**IF YOU HAVE ANY QUESTIONS OR PROBLEMS.**

Please contact us by

**TC@yooomail.com**

We will offer prompt and authoritative reply within 24 hours, and try our best to resolve your problem ASAP. If you are not satisfied with our product. Please tell us about your thought. That will be much appreciated.

# CONTENTS

<b>1.PACKING LIST</b>	<b>01</b>
<b>2.INTRODUCTION</b>	<b>02</b>
2.1 Parameter of wildlife Camera	02
2.2 Features of Wildlife Camera	03
<b>3.STRUCTURE</b>	<b>03</b>
<b>4.PREPARATION BEFORE USING</b>	<b>04</b>
<b>5.USING THE CAMERA AND SETUP MENU</b>	<b>07</b>
5.1 Using The camera	07
5.2 Setup Menu	09
5.3 Replay mode	15
<b>6.Use of WIFI</b>	<b>15</b>
<b>7.OTHER NOTICE</b>	<b>24</b>
7.1 Aligning the camera	24
7.2 Setup and ON mode	25
7.3 Night recording	26
7.4 File format	26
<b>8.CONNECTING TO COMPUTER</b>	<b>27</b>
<b>9.TECHNICAL SPECIFICATION</b>	<b>28</b>
<b>10. SIMPLE TROUBLE SHOOTING</b>	<b>30</b>
<b>11. SYSTEM INFORMATION, MAINTENANCE AND DISPOSAL TRADEMARK INFORMATION</b>	<b>31</b>
<b>12.HAZARD, SAFETY AND WARNING NOTICES</b>	<b>33</b>





# 1.PACKING LIST

Please carefully unpack camera and check that the below accessories are contained in the box.

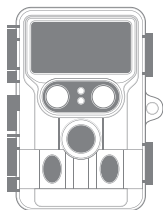

①



②



③



④

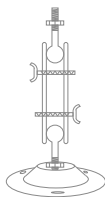

⑤



⑥

1. Wildlife Camera \* 1
2. Screws \* 3
3. User Manual \* 1
4. Mounting Belt \* 1
5. Wall Mount \* 1
6. USB cable \* 1

## **2.INTRODUCTION**

The Wildlife Camera is a wildlife and surveillance camera with an infrared sensor. The sensor can detect sudden changes to the ambience temperature within an evaluation area. The signals of the highly sensitive infrared sensor (PIR,Passive infrared sensor)switch on the camera.activating picture of video mode.

### **2.1 Parameter of wildlife Camera**

1. 60 Megapixeles real photo and 4K video
2. 60 Megapixels photo and 4K video.
3. 2.4" color TFT LCD:320 X 240 Pixels.
4. 36 pcs IR LEDs.
5. Full automatic IR filter.
6. Trigger speed: Approx. 0.1 second.
7. Setup Serial No. to record the position.
8. Time, date, temperature, phase and Serial No. will be stamped on the photo
9. Password protection.
10. Power indicating.
11. Built-in test function about environmental temperature
12. Built-in microphone and speaken
13. Mini USB 2.0 interface
14. Waterproof standard IP66.
15. Working temperature: -20°C to 60°(-4°F to 140°F).
16. Extremely low power consumption in standby operation provides quite long operating time.

## 2.2 Features of Wildlife Camera

- 1.Camera trap for hunting
- 2.Animal or incident observation.
- 3.Motion triggered security camera for domestic, office or public use.
- 4.Any internal and external surveillance.

## 3. STRUCTURE

Understanding the camera structure helps to use this product more skillfully.

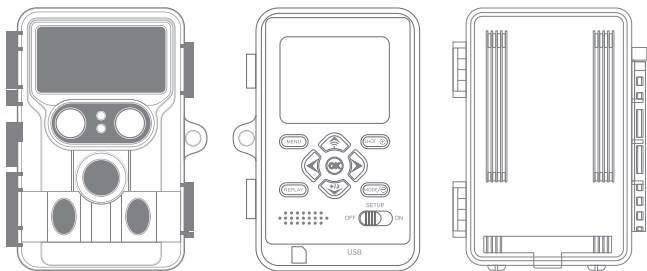

3.1 The monitor is only switched on in the SETUP mode for changing menu settings or viewing existing photos and videos.

3.2 A SD memory card must have been inserted into the memory card slot to save photos and videos

3.3 Using the Mini USB connection (USB 2.0), the camera can be connected to a computer to download photos and videos.

3.4 Using the mode switch, the three operating modes:OFF,SETUP and ON can be selected.

## 4. PREPARATION BEFORE USING



### Note:

1. SD memory cards up to a capacity of 128 GB are supported.



X8



X1



X1

2. Under low temperature and low sunlight, please use 8 AA batteries as auxiliary power supply.

3. If the built-in lithium battery of the camera is out of power, please use a 5V 1A USB adapter to charge. When using USB to charge the camera, a red indicator light at the USB interface will light up, and the camera will be fully charged after 8 hours. The red indicator light will disappear.

4. Insert CLASS 10 or higher class SD card (U3 recommend).

5. Please insert or remove the SD card when the camera is in "OFF" mode. Insert or remove the memory card in setup mode, the camera will shut itself down.

6. New memory card is recommended to be formatted when using).

7. Please note that the camera will power off when power is very low

## How to start:

Press to the right and lift up to take out the battery cover, and put 8 AA batteries in the order of the battery compartment.

Then reposition the battery cover.

Insert the Mini SD card.

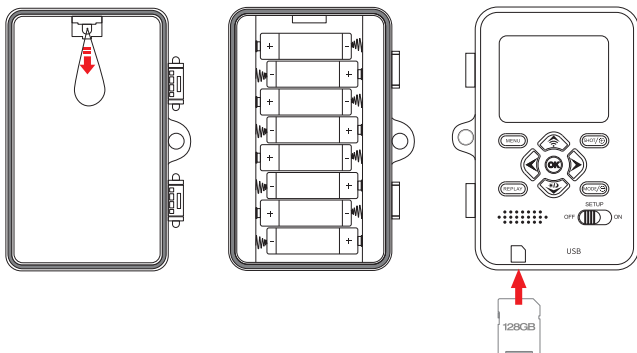

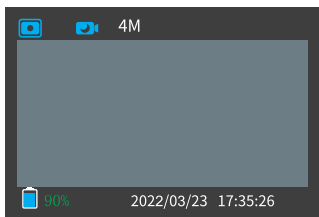
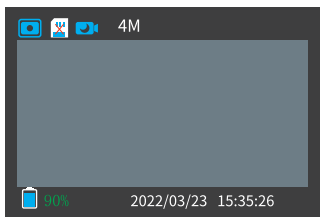











Icon	Meaning
	Photo or video mode
	SD card status
	Daytime or Night time mode
4M	Photo or Video resolution
90%	Battery percentage display
00000 22334	Can store the number of photos or the length of video recording (related to memory card capacity/pixel/resolution)
2022/03/23 15:35:26	Date and time display

## 5. USING THE CAMERA AND SETUP MENU

### 5.1 Using the Camera

Operation Buttons	
	Switch the camera mode between OFF/SETUP/ON.
	<ol style="list-style-type: none"> <li>1. Open the system settings menu</li> <li>2. In playback mode, Enter the delete file and file protection function, you can also start the "return" function on the delete page</li> </ol>
	Enter or exit playback mode
	<ol style="list-style-type: none"> <li>1. Press once to take a photo or video, press again to end the video</li> <li>2. In playback mode, Enlarge photo.</li> </ol>
	<ol style="list-style-type: none"> <li>1. Switch camera shooting mode, photo mode/video mode</li> <li>2. In playback mode, photo zoom out</li> </ol>
	<ol style="list-style-type: none"> <li>1. Turn on/off the WiFi function</li> <li>2. In playback mode, View the previous photo or video/picture and drag up to display it after zooming in</li> <li>3. Set mode in system menu, Move the option up or increase the value by 1.</li> </ol>
	<ol style="list-style-type: none"> <li>1. Click to pop up the switch camera dialog box, switch the day/night camera according to your needs</li> <li>2. In playback mode, View the next photo or video/picture and drag down to display it after zooming in</li> <li>3. Set mode in system menu, Move options down or decrease value by 1</li> </ol>
	<ol style="list-style-type: none"> <li>1. In playback mode, Start and stop video playback</li> <li>2. Set mode in system menu, Open selected item or save settings</li> </ol>
	<ol style="list-style-type: none"> <li>1. In playback mode, Rewind the video, drag the picture to the left after zooming in to display</li> <li>2. Set mode in system menu, Move left to previous numerical setting</li> </ol>
	<ol style="list-style-type: none"> <li>1. In playback mode, Fast forward the video, after the picture is enlarged, drag it to the right to display</li> <li>2. Set mode in system menu, Move right to next numerical setting</li> </ol>



## Power Switch

Shift the switch to choose working mode:

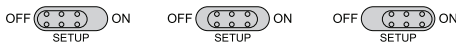

The Power Switch is used to control the camera working status.

### OFF:

The camera is completely off, only in this mode, you can unplug the memory card, replace the batteries

### Setup:

Under this mode, the camera screen is on, you can manually record video or take photos, you can also review the recorded files or change the setup options according to your own reference. When the camera is in Setup mode, the PIR sensors are on, when they are triggered, the PIR Indicators LED will flash. But in this mode, the camera will not take photos or record video when the PIR sensors are triggered.

### ON:

When the camera is switched from SETUP mode to ON mode, it will enter standby with low power consumption, screen display will turn off and button operation will be disabled. The camera will respond to the PIR sensors only. It will turn on and take photo or record videos when the PIR sensor is triggered, then return to standby afterwards.

### Notice

Prior to setting up the camera for surveillance, it must be set up for the respective purpose. For this purpose, there is a setup mode available. In addition to change settings, photos and videos can be taken and existing photos can be viewed in this mode.

## 5.2 Setup Menu



### Mode

Photo, Video, Photo+Video, Select whether photos or videos should be taken when motion is detected. When in the "Photo+Video" mode, the camera first takes a set number of photos prior to recording a video.

### PIR Interval

PIR interval can be set in the range of 5 seconds-59 minutes 59 seconds, the default is 30 seconds. After the animal is detected for the first time, after responding to the continuous triggering of the main sensor, the camera does not record any photos or videos in the selected time interval. This prevents the memory card from filling up with unnecessary lenses. The shorter PIR interval, the higher frequency of camera shooting, and the higher power consumption will affect the battery life. On the contrary, if the delay time is long, the power consumption will be reduced to ensure the long-term use of the battery.

### PIR Sensitivity

High/Medium/Low, default Medium

Select sensitivity according to application conditions. Select "High" For interior areas and environments with little interference. Select "Medium" for exterior areas and environment with a normal amount of Interference, Select "Low" for an environment with a high level of interference.

### Time lapse

Press "ON" to set the time interval, and set the values of H, M and S. For example, if the process of flowers blooming has to be recorded, time lapse can be used.

The camera automatically takes pictures in every set time intervals. Default off.

Notice:

If you select "ON", PIR Interval and PIR Sensitivity will not be available!

## **IR LED**

Default Auto.

Used to set the brightness of the infrared fill light.

Auto is the strongest brightness for shooting long-distance wild animals at night.

Medium is medium brightness for shooting mid- and long-distance wild animals at night. Low is low brightness for shooting close-up wild animals at night.

Off is to turn off the infrared light and shoot at night all black files.

## **Low Bat Night Shot**

Default No shutting.

No shutting : The camera will not take pictures or videos under low power conditions.

No IR Led : Take all black photos and videos after the wild camera is triggered under low power conditions.

## **Monitoring Period**

Timer 1 Start/Timer 1 Stop

Timer 2 Start/Timer 2 Stop

Select "ON" to turn on this function, and set the Timer 1 and Timer 2 to set the starting working and ending working time.

After finishing setting, the camera only works during the set time every day.

Beyond the period, the camera is in standby. If the start time is, for Instance set to 18:35 and the end time to 8:25, the camera will be operational from 6:35 pm of the current day until 8:25 am of the following day. The camera will not be triggered and will not take any photos or videos beyond of this period.

## **Night shoot mode**

The default "Auto" mode of the system starts the IR lamp fill light when shooting in the environment with insufficient brightness.

Video files/photos are in black and white; when the shooting environment has a certain basis and brightness, you can choose

"More Color" mode for more color videos and photos.



### **Image Size**

Day time:60M/52M/48M/36M/24M/13M .Default 36M

Night time:8M/4M/2M .Default 4M

Select the desired resolution for photos. A higher resolution produces a somewhat better photo quality but results in larger files requiring more space on the memory card.

### **Picture NO**

1P/2P/3P/4P/5P/6P/7P/8P/9P/10P available. Default 1photo.

After triggering the wild camera, continuous shooting can be performed according to the number of photos selected.

### **Shutter speed**

Wild camera shooting speed. 1/15, 1/20, 1/30 available Default 1/30.



## Resolution

Day time: 4K 30FPS/2.7K 30FPS/2K 60FPS/2K 30FPS/1080P 60FPS/1080P 30FPS/720P 30FPS. Default 4K 30FPS.

Night time: 1080P 30FPS/720P 30FPS. Default 1080P 30FPS. Select the required video resolution. A higher resolution produces higher quality videos but results in larger files requiring more space on the memory card. Videos are recorded in MP4 format which can be played back on most video devices.

## Video length

Default 10 seconds, optional 5s-180s, Specify the duration of a video recording when the camera is triggered automatically.

In the SETUP mode in daytime and at night.

> When recording manually, the camera will stop automatically after 29 minutes' recording;

> When recording manually, the camera will stop when one video clip size gets to 4 GB

> When recording manually, the camera will stop when the memory card is full or low power.

In live mode (ON) at night the camera will work automatically as per the video length setting. For low power, it will stop recording. Please set the shorter video length in advance to guarantee a long-time usage of batteries.

## NOTICE:

Video recording will consume significantly more power than taking photo, especially at night with IR LED on. Please set a shorter video length to ensure battery life. The power consumption of 10 seconds video recording is the same as 150 photos.

## Record Audio

Turn on/off audio recording. Default "On"



## Language

Select the menu language.

English /French/Spanish /Portuguese/German/Italian/Chinese/ Japanese available.

## Default Setting

Reset the camera to default. After the reset, the camera will let you select the language and date, and set whether the memory card is formatted or not.

## Format

Format the memory card.

## Date/Time

Select Date/Time and press OK to change the Date/Time setting. Use the UP and Down button to adjust values, press left or right switch to next digit. After setting the time and date, press Menu button to exit Date/Time setting.

## Time Format

Choose 12 hours system or 24 hours system.

## Date Stamp

Turn on/off display of date watermark on photo.

## Beep Sound

Turn on/off button operation beep sound.

## **Camera Name**

Setup the camera name and it will be display in the photo watermark. Default TC06.

## **Password Setting**

Setup a start up password to protect the camera. Default off.

## **Bluetooth**

Turn on and off Bluetooth. Default ON.

## **WIFI SSID**

Camera WIFI name, you can change the camera name by pressing the up, down, left, and right buttons. Default TC06.

## **WIFI Password**

Camera WIFI password, you can change the camera WIFI password by pressing the up, down, left, and right buttons. Default 12345678.

## **Auto WIFI Off**

When the camera does not connect to the phone within the set time after the camera is turned on WIFI, the camera WIFI will be automatically closed.

## **Auto Power Off**

3 min/5 min/10 min/off If there is no operation more than the selected time, then the camera will turn off automatically in SETUP mode. Default 3min.

## **Backlight**

1Minute, 3Minutes, 5Minutes, Off. Default 1Minute.

The LCD monitor would automatically turn off after the setting time.

## Version

This is camera version number.Default "TC06\*\*\*\*".

## Mcu FW Update

Firmware upgrade settings.

## 5.3 Replay mode



### Notice:

In playback mode, long press the menu button to delete and lock the file.

## Delete

Select the "Delete" option to remove individual or all photos and videos from the memory card thus making storage room for new photos and videos.

## 6.Use of WIFI

Before using the WiFi function, please install the APP application on the smartphone device. Please download and install the app by searching "Game Camera Pro2" for the Android system(Google Play), searching "Game Camera Pro" for the IOS system(APP store).



IOS





Android

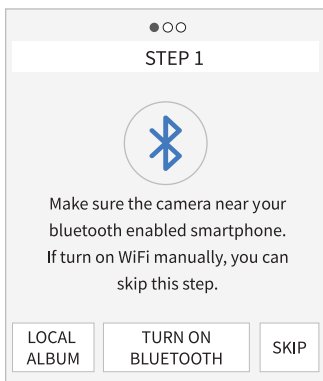

## Connect the Bluetooth

Slide the mode switch of the camera to the TEST or ON position, and then turn on the mobile phone click the app and enter STEP1 as show in the following figure.



1. Click to enter "LOCAL ALBUM", users can view the picture or video which they download before.
2. When the user doesn't want to use the Bluetooth function, just press the  button on the camera to open the WiFi directly. And press "Skip" in the APP to enter Wifi interface.
3. Click "TURN ON BLUETOOTH", and turn on the Bluetooth accordingly to this prompt of the APP. The APP will enter "STEP2" and automatically search Bluetooth device by itself, as the figure shown below:

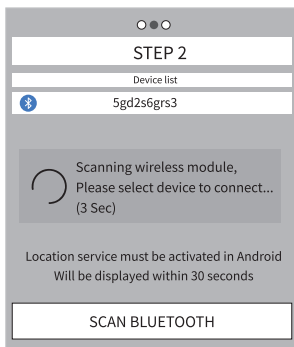

4. The searched Bluetooth devices are arranged and displayed under the "device list", as shown below:

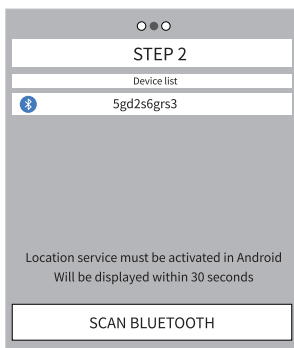

5. Click the appropriate Bluetooth device, APP would connect with the camera Bluetooth. The mobile phone will pop up the window "Connecting,,,, please wait....". After successful connection the APP would enter into the "STEP 3", and then the camera Bluetooth match successfully with the mobile phone Bluetooth.

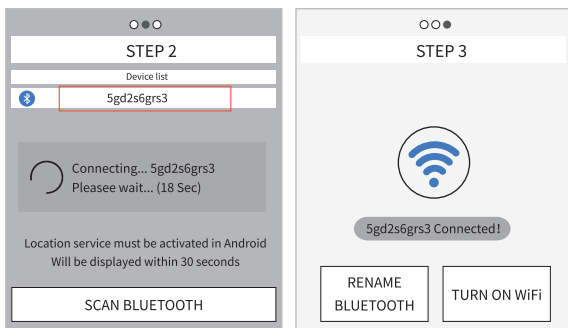

## WiFi connection

When the Bluetooth connection is successful, the APP would enter "STEP 3" as shown below diagram.

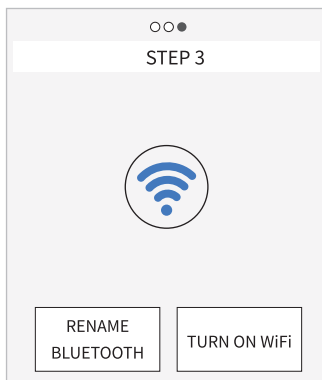

1. Click “RENAME BLUETOOTH”, user could modify the Bluetooth device name accordingly to their own needs, after the modification, click “OK” button and save it. Details as below :

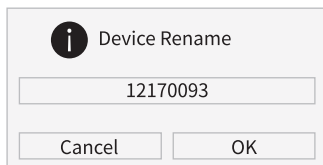

2. Click “TURN ON WiFi”, after 5s countdown, it would jump to the interface of “WiFi SETTING”, Details as below :

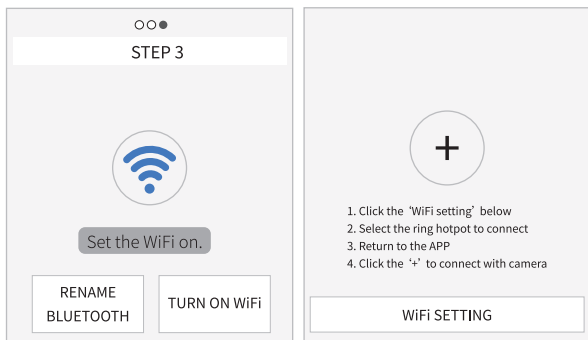

When the camera receives the command to turn on WiFi, the hotspot would be turn on as below shown.

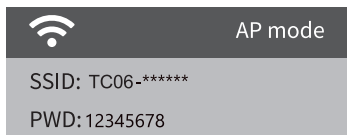

Operate the steps 1~4 following the “WiFi SETTING” interface.

a. Click the “WiFi SETTING” button as below shown.

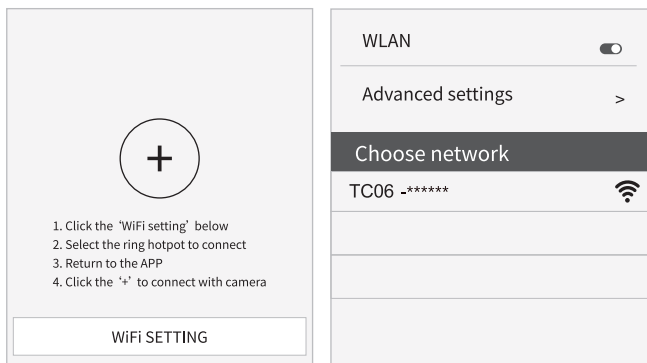

b. Connect with the correct WiFi hotspot, the initial password is 12345678.

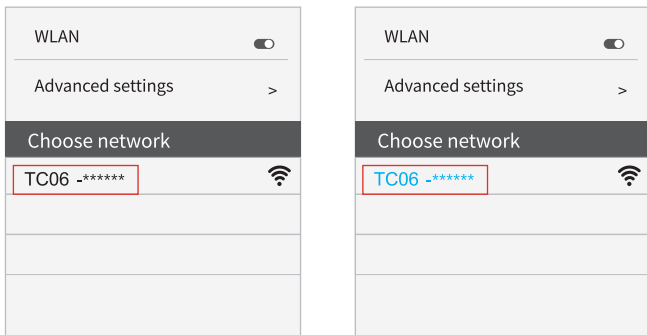

After successful connection, the interface display in the camera as below shown:

WiFi Connected  
Mac: d8c7714fffc9  
Press UP to Disconnect



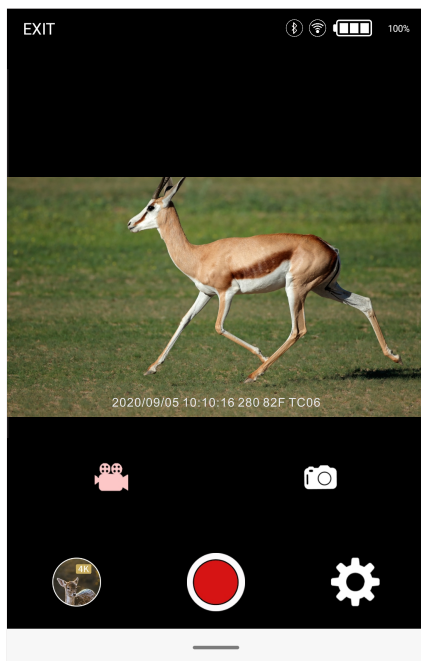



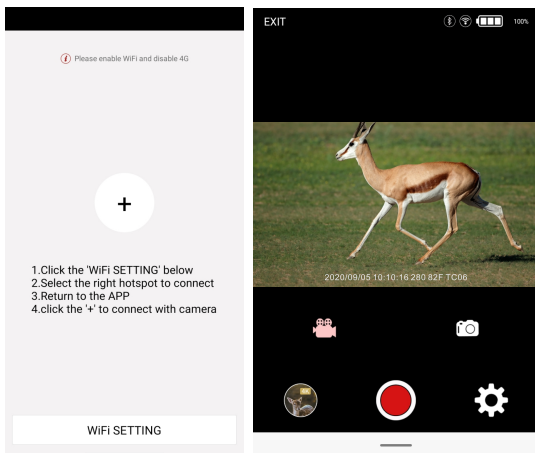

c. Return back to APP after the WiFi successful connection. And then the APP would automatically connect with camera. or click "+" to connect manually.



## APP connection





1. When the APP and camera connect successfully, the interface as below shown:



	The connection between camera and mobile phone		
EXIT	Turn off the APP, the Bluetooth and WiFi functions between mobile phone and camera would be turn off at the same time.		
	The display of signal strength indicator		
	Camera battery level display		
	Switch to Video mode		Switch to Taking photo mode
	Mobile phone review pictures or video in the camera		
	Connect the camera to video mode or taking photo mode under the control of Mobile phone		
	Camera System Setting function. <b>Notice:</b> This setting function is synchronized with the camera system setting function. It realizes through the way of wireless.		

2. Click the icon  to enter the pictures review as shown below.



	Select the picture or video to download, and press the button to save files to mobile phone.
	Press this icon to delete the selected the picture or video. After the picture or video is deleted, the file could not be recovered, please use it with caution.
	Select all the files.
	Toggle Switch, the switch between picture review and video

3. Click the icon  to enter the menu setting, as shown below diagram.

Setting	
Mode	Photo>
Image Size	24M>
Sampling(valid in 'ON' mode)	1 Photo>
Resolution	2K>
Record Time(valid in 'ON' mode)	00:10>
PIR Interval	00:30>
PIR Sensitivity	Med>
IR LED	Auto>
Time Lapse	Off>
Timing Interval	



## 7.Other notice

### 7.1 Aligning the camera

The Test mode is advantageous for determining the best possible detection angle and range of the movement sensor. For this purpose attach the camera at approx. 1-2 m height to a tree and align the camera with a desired direction. Move slowly from one side of the observed area to the other, Move parallel to the camera. Try out different angles and distances.

The red LED indicator on the front of the camera lights up to indicate that you have been detected by the PIR sensor area.

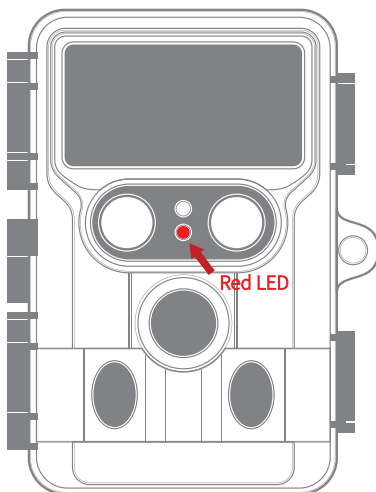

In this way you can determine the best position for aligning the camera. The LED only lights up in the SETUP mode as soon as of the sensors has detected movement. The LEDs do not light up when in ON mode. In order to prevent incorrect signals and unnecessary photos, we recommend using the camera at sunny points and check that no branches are in the active area of the sensor. Optimum alignment is in North or South direction. The detection range of the sensors is approx 120°. Also check that the camera is set to the correct height in line with the point to be observed. Where necessary, point the camera down for optimum alignment.



#### **Notice:**

Wildlife Camera corresponds to protection class IP 66. The camera is protected against dust and spray water and thus it can be used in any weather condition.

## **7.2 Setup and ON mode**

The standard application of the Wildlife Camera is the Live mode, When in this mode, photos are either triggered by movement sensors or at intervals according to the respective setting. To set up the Live mode, switch mode switch to ON position. The red status LED flashes for approx. 5 seconds before the camera operates automatically and enters the Standby mode.

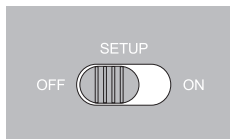

## 7.3 Night recording

During night recording the infrared LEDs (IR LEDs) at the front of the Wildlife Camera provide the light required for taking photos. Wildlife Camera uses IR LEDs with a long wavelength to keep red light to a minimum. The provided number of IR LEDs generates a high deflection angle thus allowing night recording at a distance of 3 m to 20 m, without overexposing the object. Reflecting objects can, however, also cause overexposure within this range (e.g. road signs). Please note that night recording using IR LEDs produces black and white images.

## 7.4 File format

The Wildlife Camera stores photos and videos on the memory card in the folder "DCIM ". Photos are given a file name with extension "JPG" (Example: "IM\_00001.JPG"). videos, are given the extension ".MP4" (Example: "VD\_0001.MP4"). When in SETUP and OFF mode use the enclosed USB cable to transfer files onto the computer. Alternatively you can insert the memory card in a card reader on the computer.

**The video file can be played with most standard programs, such as Windows Media Player, PotPlayer etc.**

## 8.Connecting to computer

The Wildlife Camera can be connected to a computer using the supplied USB cables to view existing photos/videos.

### System requirements

Windows	Macintosh
<ul style="list-style-type: none"><li>■ Pentium III or higher</li><li>■ Windows XP/Vista/7/8/10</li><li>■ 512 MB RAM</li><li>■ 1GB available hard disk space</li><li>■ Screen resolution 1.024 x 768 or higher</li><li>■ Available USB connection</li></ul>	<ul style="list-style-type: none"><li>■ PowerPC G3/G4/G5</li><li>■ OS 10.3.9 or newer system</li><li>■ 512 MB RAM</li><li>■ 1GB available hard disk space</li><li>■ Screen resolution 1.024 x 768 or higher</li><li>■ Available USB connection</li></ul>

- 1.Connect the camera to your computer using the USB cable.
- 2.The camera switches on automatically in the USB mode, irrespective of the selection on the mode switch.
- 3.The camera installs itself on the computer as an additional drive under the name "Removable storage device".
- 4.Double click on the device to detect the folder "DCIM".
- 5.The photos and videos are located in the sub folders of the "DCIM" folder.
- 6.You can copy or move photo and video files on the computer. Alternatively you can insert the memory card in a card reader on the computer.

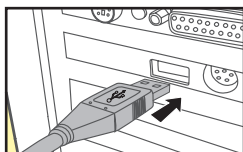

### Note:

- Mac computers show an "Unknown" drive on the desktop. When clicking on this drive, the program "iPhoto" is automatically started.

## 9. Technical specification

Image and Video	
Image sensor	13 Mega pixels, 1/3" CMOS sensor
Photo resolution	Day time:60M/52M/48M/36M/24M/13M. Night time:8M/4M/2M.
Screen	2.4" colour TFT LCD; 320 x 240 pixels
Lens	F=4.3; F/NO=2.0; Auto IR filter
Triggering time	approx. 0.1 second
Video resolutions	Day time:4K 30FPS/2.7K 30FPS/2K 60FPS/2K 30FPS/ 1080P 60FPS/1080P 30FPS/720P 30FPS. Night time:1080P 30FPS/720P 30FPS.
Effectiveness	Daytime: 1 m - infinite; Night time: 3 m - 20 m
Storage formats	Photo: JPEG; Video: MP4

Audio	
Microphone	48 dB high sensitivity sound collection
Buzzer	2700HZ, 85dB

Trigger	
Detection angle of sensors	Total sensor angle zone: 120°
Triggering distance	up to 20 metres
PIR Sensitivity	High / Medium / Low

### Data Storage

Recording medium	Supports SD/SDHC memory cards up to 128 GB (optional)
------------------	---

### Night vision

Day / Night Mode	Day/night, Auto Switching
IR-CUT	Built-in
IR flash	850nm infrared LEDs range 20m

### APP

System Requirements	IOS 9.0 or Android 5.1 above
Real-time Video Preview	Only supports AP mode, Direct Video Connection, easy to install and test
APP Function	Installation target, parameter setting, time synchronization, shooting test, power warning, SD/SDHC card warning, PIR test, full screen preview
Quick Parameter Setting	Supported
Online Data Management	Video, Photos, Events: Support online Viewing, Deletion, Download

### Power Supply and Power Consumption

Power supply	8x batteries type LR6 (AA);
Standby time	approx. One years (When the sunlight is full)

Others	
Spray water protected	Yes (IP protection class66)
Connections	Mini USB 2.0
Dimensions	approx. 145 (H) x 105(B) x 95 (T) mm



### Note:

- Design and technical specification are subject to change.

## 10. Simple Trouble Shooting

The camera will not turn on	<ul style="list-style-type: none"> <li>• Please check the batteries if they are installed in proper way.</li> <li>• Check if the battery capacity is low or exhausted. If so, please replace them with new batteries.</li> </ul>
The camera turns off automatically	<ul style="list-style-type: none"> <li>• Please check whether the battery capacity is low or exhausted. If so, try to change new batteries for outdoor using or connect AC adaptor for indoor using.</li> <li>• Please check if SD card is full. If so, transfer images and videos to your computer or delete some files in the Replay Mode.</li> </ul>
It shows “SD card Error”	<ul style="list-style-type: none"> <li>• Please ensure that SD card is with class 10 standard or higher level.</li> <li>• Please use the camera to format SD card at the first time.</li> </ul>
Videos are choppy or jumpy when played on a computer	<ul style="list-style-type: none"> <li>• Ensure that the computer system requirements are met.</li> <li>• Ensure MP4 format Video clip can be played on your computer.</li> </ul>
The image is not clear	<ul style="list-style-type: none"> <li>• Please ensure that you removed the protective films on IR LEDs and lens before using.</li> <li>• Please ensure that the lens is not dirty.</li> </ul>

The camera does not take images or record videos	<ul style="list-style-type: none"> <li>• If the memory of SD card is full, transfer images or videos to your computer or delete some files in the Replay Mode.</li> <li>• The memory card is not formatted properly. Format the SD card again or use a new card.</li> </ul>
Camera can not turn off	<ul style="list-style-type: none"> <li>• Once such malfunction occurs, remove all the batteries to reset the camera.</li> </ul>
Forget the password	<ul style="list-style-type: none"> <li>• Please enter the words “OPEN”, in case that you forget the password to start the machine.</li> </ul>

## 11. System information, Maintenance and Disposal Trademark information

- Microsoft® and Windows® are trademarks of Microsoft Corporation registered in the US.
- Pentium® is a registered trademark of Intel Corporation. Macintosh is a trademark of Apple Computer Inc.
- SD™ is a trademark.

### 11.1. Care

Do not use any corrosive cleaners, such as methylated spirits, thinners, etc. to clean the camera housing and supplied accessory. When required, the clean system components with a soft dry cloth.

### 11.2. Storage

Always remove the battery from the housing if the camera is not being used for some time and store the battery separately. Please keep the batteries at a dry location out of the reach of children.



### 11.3. Disposal

For disposal, separate packaging into different types and dispose of in line with environmental regulations in supplied collection containers. Batteries and storage batteries may not be disposed of in domestic waste. Consumers are obliged by law to return used batteries to communal collection points or dealers selling batteries. Storage batteries and batteries do therefore contain the adjacent symbol.

Correct disposal of product:

The adjacent symbol indicates that electrical and electronic equipment may not be disposed of in domestic waste in the EU. Please use the returns and collection points of your local council or contact your dealer you purchased the product from. This prevents potentially harmful effects on the environment and health as a result of incorrect disposal. For further information contact the respective department of your local council.

## **12. Hazard, safety and warning notices**

Incorrect use of the camera and accessories can be dangerous for you and others and also damage or destroy the camera. We therefore ask you to read . and strictly observe the following Hazard, safety and warning notices.

### **12.1 Intended use**

This camera is intended for taking digital photos and video clips. It has been designed for private use and is not suitable for commercial purposes.

### **12.2 Hazards for children and persons with limited ability to operate electronic equipment**

The camera, accessory and packaging are not toys for children. These should therefore always be kept away from children. Danger of electrocution, poisoning and suffocation.

The camera and accessory may not be used by children and persons with limited abilities. The camera may only be operated by persons physically and mentally able to operate it safely.





