

此页不印刷（本文件共32页）

SIZE:115mm X 165mm

材质: 封面铜版纸 内页: 书纸

工艺: 封面过亚膜

 PANTONE Black C

注意：不要随便删减空白页（特别是封面内页不能出现印刷内容）

T90

Trail Camera

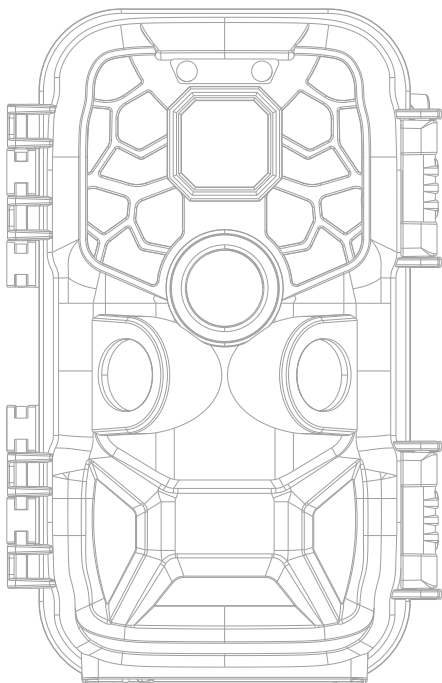

Instruction Manual

CONTENT

* INSTALLATION STEPS -----	1
1.PACKAGE LIST-----	3
2.INTRODUCTION-----	3
2.1.Parameter of Wildlife Camera-----	3
2.2.Features of Wildlife Camera-----	4
3.STRUCTURE-----	4
4. PREPARATION BEFORE USING-----	7
5.USING THE CAMERA AND SETUP MENU-----	9
5.1 Using The Camera-----	9
5.2 Setup Menu-----	11
5.3 WIFI APP connection-----	16
5.3.1 Connect the Bluetooth-----	16
5.3.2 WIFI connection-----	18
5.3.3 APP connection-----	19
6.INSTALL THE CAMERA IN THE FIELD-----	21
7.Enter ON / Live Mode-----	22
8.TECHNICAL SPECIFICATION-----	23
9.SIMPLE TROUBLE SHOOTING-----	24

IF YOU HAVE ANY QUESTIONS OR PROBLEMS.

Please contact us by

support@campark.net

We will offer prompt and authoritative reply within 24 hours, and try our best to resolve your problem ASAP. More Safe Guarantee with CAMPARK! If you are not satisfied with our product. Please tell us about your thought. That will be much appreciated.

* INSTALLATION STEPS:

There are two ways to mount the Campark trail camera: using the provided adjustable web belt, or the tripod socket.

1. Using the Adjustable Mounting Belt

Push one end of the belt through the brackets on the back of the camera. Thread the end of the strap through the buckle. Fasten on the belt securely around the tree trunk by pulling the end of the strap firmly so there is no slack left.

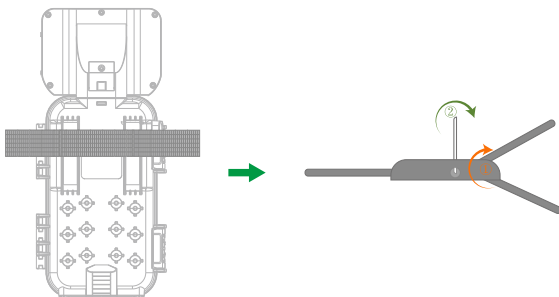

2. Using the Tripod Socket

The camera is equipped with a chassis at the bottom and to enable mounting on a bracket we provided.

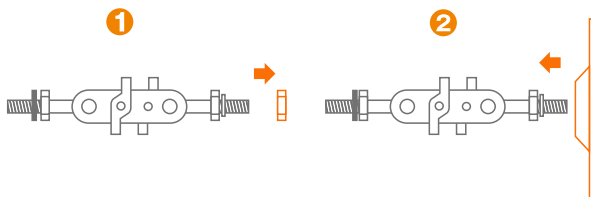

1.Remove a nut from the fixed bracket (Be careful not to drop the iron ring from the bracket).

2. Insert the bracket into the chassis.

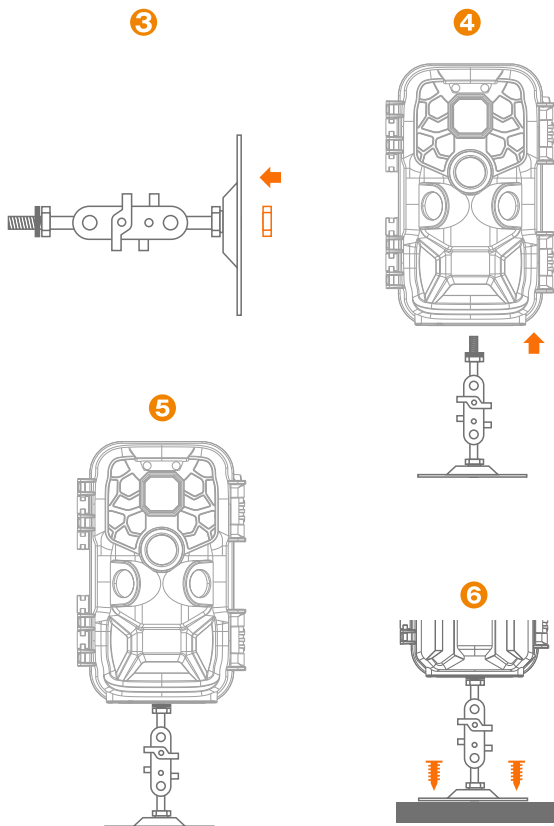

3. Fix the bracket to the chassis with the removed nut.
4. Fix the camera to the bracket.
5. Assembly is complete. They can be made stronger by turning the swivel screws on the bracket.
6. Use wall anchors and screws to fix the camera on the wall (plank, etc.).

1. PACKAGE LIST

Please carefully unpack camera and check that below accessories are contained in the box.

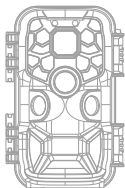

1



2



3



4

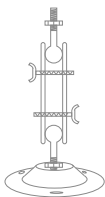

5



6

1. Wildlife Camera * 1
2. Screws * 3
3. User Manual * 1
4. Mounting Belt * 1
5. Wall Mount * 1
6. USB cable * 1

2. INTRODUCTION

The Wildlife Camera is a wildlife and surveillance camera with an infrared sensor. The sensor can detect sudden changes to the ambient temperature within an evaluation area. The signals of the high-sensitivity Infrared sensor (PIR, passive infrared sensor) switch on the camera, activating picture or video mode.

2.1 Parameter of Wildlife Camera

1. CMOS sensor.
2. 24 Megapixels photo and 4K Lite video.
3. 6.1 cm (2.4") color TFT LCD: 320x240 pixels
4. 38 pcs IR LEDs.

5. Full automatic IR filter.
6. Trigger speed: Approx. 0.2 second.
7. Setup Serial No. to record the position.
8. Time, date, temperature, phase and Serial No. will be stamped on the photo.
9. Password protection.
10. Power indicating.
11. Built-in test function about environmental temperature.
12. Built-in microphone and speaker.
13. Mini USB 2.0 interface.
14. Waterproof standard IP66.
15. Working temperature: -20°C to 50°C (-4°F to 122°F).
16. Extremely low power consumption in standby operation provides quite long operating time. 8 AA batteries will last 6 months if 50 pictures are taken everyday.

2.2 Features of Wildlife Camera

1. Camera trap for hunting
2. Animal or incident observation.
3. Motion triggered security camera for domestic, office or public use.
4. Any internal and external surveillance.

3. STRUCTURE

Understanding the camera structure helps to use this product more skillfully.

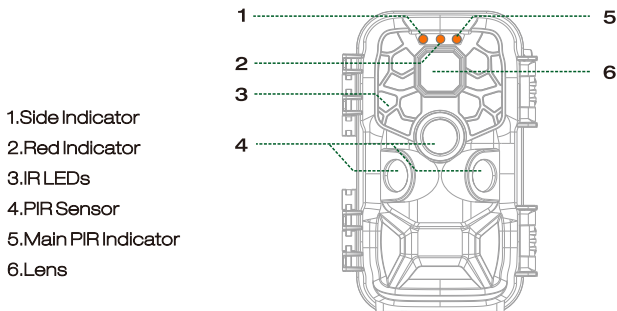

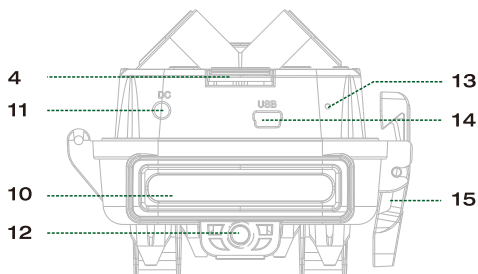
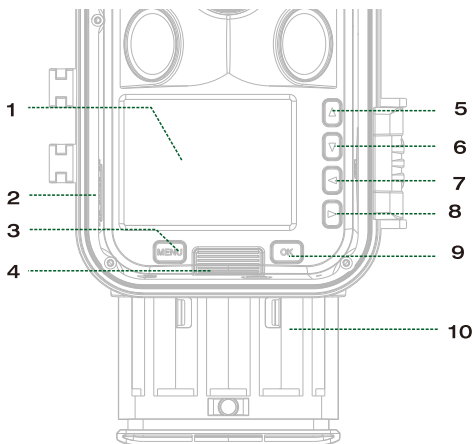

- | | |
|--------------------|--------------------------|
| 1.Screen | 9.OK |
| 2.Power Switch | 10.Battery Case |
| 3.MENU | 11.DC Power Input |
| 4.Battery Ejection | 12.Mount Screw |
| 5.UP | 13.Microphone |
| 6.Down | 14.Mini USB |
| 7.Left | 15.Locking hole for lock |
| 8.Right | |

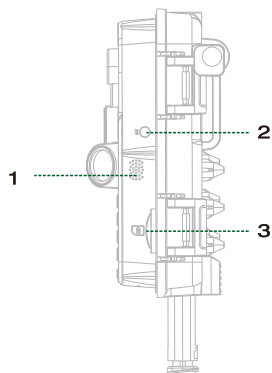

1.Speaker 2.AV Out 3.Memory card slot

- ▲ 1. Using the mode switch, the three operating modes: OFF, SETUP and ON can be selected.
- 2. To change menu settings or view existing photos and videos, please make sure the mode switch is on the SETUP mode.
- 3. An SD memory card must be inserted into the memory card slot to save photos and videos.
- 4. Using the mini USB connection (USB 2.0), the camera can be connected to a computer to download photos and videos.

4. PREPARATION BEFORE USING

Note :

1. SD memory cards up to a capacity of 128 GB are supported.

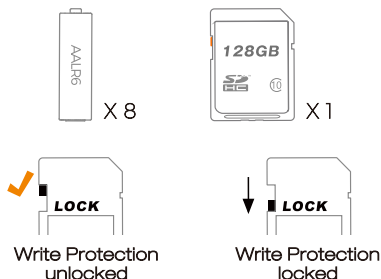

2. For best using experience, we recommend using 8 alkaline batteries to power the camera. Lithium-ion rechargeable batteries are not recommended because rechargeable batteries have lower voltage output and poor performance under low temperature.
3. The camera must be inserted 4 or 8 x 1.5V AA batteries . Do not use new and old batteries together. DC interface need 6V/2A adaptor with 3.5 mm (outer diameters) *1.3 mm (inner D) plug head.
4. Insert CLASS 10 or higher class SD card (U3 recommend).
Before insert into memory card, ensure that the lateral write protection on the memory card has been unlocked.
5. Please insert or remove the SD card when the camera is in "OFF" mode.
6. New memory card is recommended to be formatted when using (as below described).
7. Please note that the camera will power off when power is very low.

How to start:

Push the release button to eject the battery case

Load 8 new alkaline batteries

Install the battery case

Insert the SD card

Switch to Setup

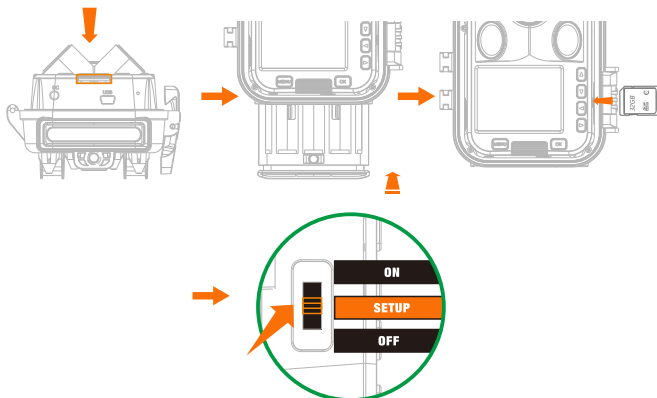

5. USING THE CAMERA AND SETUP MENU

5.1 Using The Camera

1. Operating Buttons

Button	Function
MENU	<ul style="list-style-type: none">● In Video/Photo/Playback mode enter settings● In setup menu, short press to exit current menu.● In Playback mode, short press delete files
Power	<ul style="list-style-type: none">● Switch the camera mode between OFF / SETUP / ON
UP	<ul style="list-style-type: none">● In Playback mode, Scroll through the recorded files.● In Setup menu, Scroll through the setup menu and adjust values.● Long press to turn on WIFI.
OK	<ul style="list-style-type: none">● In Video mode, short press to start recording video manually.● In Photo mode, short press to take a photo manually.● In Setup menu, short press to confirm selection and changes.● In Playback mode, play video.
Down	<ul style="list-style-type: none">● In Playback mode, Scroll through the recorded files.● In Setup menu, Scroll through the setup menu and adjust values.
Left Key	<ul style="list-style-type: none">● Short press to adjust when setting multiple digits in the menu.
Right Key	<ul style="list-style-type: none">● Short press to adjust when setting multiple digits in the menu.● In Video or Photo mode, short press to enter playback mode.
Battery Ejection	<ul style="list-style-type: none">● Push to eject the battery case.

2. Power Switch

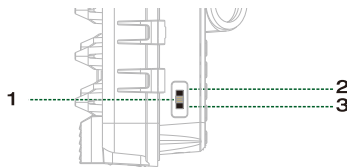

1. SETUP 2. ON 3. OFF

2.1 Shift the switch to choose work mode:



ON SETUP OFF

Power off (OFF)



ON SETUP OFF

Setup system (SETUP)



ON SETUP OFF

Live mode (ON)

The Power Switch is used to control the camera working status.

OFF:

The camera is completely off, only in this mode, you can remove the memory card, replace the batteries.

Setup:

Under this mode, the camera screen is on, you can manually record video or take photos, you can also review the recorded files or change the setup options according to your own preference.

When the camera is in Setup mode, the PIR sensors are on, when they are triggered, the PIR indicators LED will flash. But in this mode, the camera will not take photos or record video when the PIR sensors are triggered.

ON:

When the camera is switched from SETUP mode to ON mode, it will enter standby with low power consumption, screen display will turn off and button operation will be disabled. The camera will respond to the PIR sensors only. It will turn on and take photo or record videos when the PIR sensor is triggered, then back to standby afterwards.

5.2 Setup Menu

Camera mode

Photo, Video, Photo+Video

Select any mode that you need. In "Photo" mode, the camera only takes photos. In "Video" mode, the camera only records videos. In "Photo+Video" mode, the camera takes a set number of photos before records a video.

Photo resolution

24M / 20M / 16M / 12M / 8M / 5M / 3M Available

Select the desired resolution for photos. A higher resolution produces a somewhat better photo quality but results in larger files requiring more space on the memory card.

Multi-shot

1P/2P/3P available

Video resolution

3840X2160P Lite, 2688X1520P, 1920X1080P, 1280X720P, 720PX480P

Select the required video resolution.

A higher resolution produces higher quality videos but results in larger files requiring more space on the memory card. Videos are recorded in AVI format which can be played back on most video devices.

Video Length

Default 5 seconds, optional 3s-180s,

Specify the duration of a video recording when the camera is triggered automatically. The recording period for videos is not limited in the SETUP mode.

In the SETUP mode in daytime and at night.

- > When recording manually, the camera will stop when one video clip size gets to 4 GB,
- > When recording manually, the camera will stop when the memory card is full or camera is in low power.

In the ON mode in daytime and at night.

- > In live mode (ON) the camera will work automatically as video length set in advance. In low power, it will stop recording.
- > Please set shorter video length to guarantee a long-time usage of batteries.

NOTICE:

Video recording will consume much more power than taking photos, especially at night with IR LED on. Please set a shorter video length to ensure battery life.

The power consumption of 10 seconds video recording is the same as 150 photos.

PIR Interval

> 5 second ~ 59 minutes 59 seconds, default 1 minute

Select the period between finishing last shot and next sensor trigger.

The camera does not record any photos or videos during the selected interval. This prevents the memory card from being filled with unnecessary shots.

The PIR interval is short, the camera shooting frequency will be high, and there will be high consumption of the power. It will affect the life of the batteries. On the opposite, if the shot lag is long, there will be a lower consumption of power.

PIR sensors sensitivity

High / Medium / Low, default Medium

Select the sensitivity according to the applied conditions.

Select "High" for interior areas and environments with little interference

Select "Medium" for exterior areas and environment with a normal amount of interference,

Select "Low" for an environment with a high level of interference.

Time Lapse

Press "ON" to set the time interval, and set the values of Hr, Min and Sec.

For example, if the process of flowers blooming has to be recorded, time lapse can be used. The camera automatically takes pictures in every set time intervals.

Working timer

ON/OFF

Select "ON" to turn on this function, then set the Timer 1 and Timer 2 to set the starting working and ending working time.

After finishing setting, the camera only works during the set time every day. Beyond the period, the camera is in standby. If the start time is, for instance set to 18:35 and the end time to 8:25, the camera will be operational from 6:35 pm of the current day until 8:25 am of the following day. The camera will not be triggered and will not take any photos or videos beyond this period.

Audio recording

Turn on/off audio recording

Side PIR Setup

ON/OFF

Time & date

Set time & date, Time format, Date format

Select the date/time and press OK to change the date/time setting. Use the up and down keys to adjust the value, press OK to confirm the change, and short press the right key to switch to the next digit. After setting the time and date, press the MENU button to exit the date/time setting.

Choose 12 hours system or 24 hours system.

Turn on/off display of date watermark on photo.

Photo stamp

Select camera watermark.

Beep Sound

ON / OFF

Turn on/off button operation beep sound.

Language

Select the menu language.

English / French / Spanish / Portuguese / German / Italian / Chinese available.

Password Setting

Setup a startup password to protect the camera. Only four-digit password.

WIFI SSID

ON/OFF, default ON

WIFI name

default Campark-T90

WiFi Password

Default 12345678

Auto WiFi Off

Setup the time so the camera will automatically turn off WiFi when it is not connected to a smart phone within the preset time.

Format memory card

Format the memory card.

Reset settings

Cancel /OK Press OK to reset the camera settings to the default values.

Version

Check firmware version.

5.3 WIFI APP connection

Before using the wifi function, please install the APP application on the smartphone device. Please download and install the app from Google Play or APP store by searching “Hunting Camera” APP for Android system and IOS system.



IOS



Android

5.3.1 Connect the Bluetooth

Slide the camera mode switch to the test or ON position, turn on the phone, and tap the app to enter the main interface of the app, as shown in the figure below.



1. Click to enter "📷", users can view the picture or video which they download before.
2. When the user doesn't want to use the Bluetooth function. Long press this button 📶 on the camera to open the WiFi directly. And press "Skip" in the APP to enter Wifi interface.
3. Click "Step One Bluetooth On WIFI", and turn on the Bluetooth according to the prompt of the APP. The APP will automatically searches Bluetooth.
4. The searched Bluetooth devices will display under the "Bluetooth List", as shown below:
5. Tap the corresponding Bluetooth device, the APP will connect with the camera Bluetooth. The phone will pop up the "Connect, please wait..." window. If the camera Bluetooth is successfully matched with the mobile phone's Bluetooth, the device WIFI will be turned on automatically.

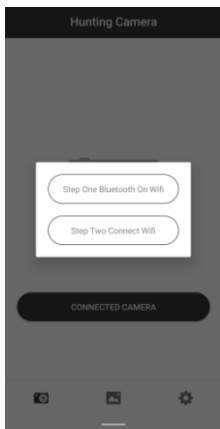

(3)

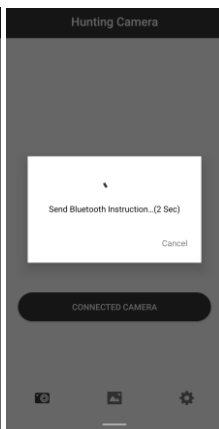

(4)

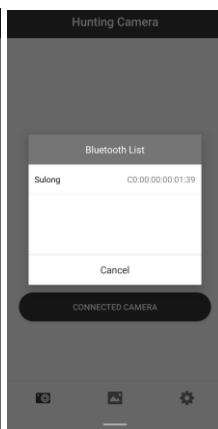

(5)

5.3.2 WIFI connection

A. After the Bluetooth connection is successful, the APP will enter the mobile WIFI setting interface, as shown in the figure below.

B. When the camera receives the command to turn on WiFi, the hotspot will be turned on as shown below.

C. Connect with the correct WiFi hotspot, the initial password is 12345678.

D. After successful connection, the interface display in the camera will show as below:

E. Return back to APP after the WiFi is connected successfully, and then the APP will automatically connect with camera.

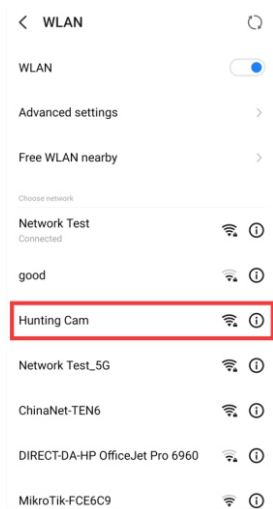

(A)

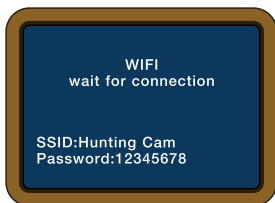

(B)

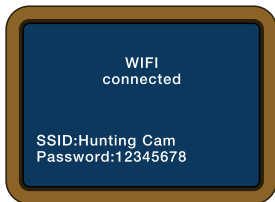

(D)

5.3.3 APP Connection

1. When the APP and camera connect successfully, the interface will show as below:

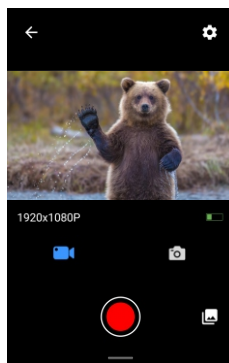

	Turn off the APP, the Bluetooth and WiFi functions between mobile phone and camera will be turned off at the same time.
	Camera System Setting function. Notice: This setting function is synchronized with the camera system setting function, so you can set the functions on the app.
1920x1080P	Display the resolution of the photo or video.
	Camera battery level display.
	Switch to video mode.
	Switch to photo mode.
	Start to record video or take pictures.
	View pictures or videos in the camera.

2. Click the icon to enter the pictures review as shown below.

A. Click on the photo file to zoom in and view, download or delete the file.

B. Click on the video file to download

C.  , Multi-select video or photo files, then download or delete.

3. Click the icon  to enter the menu setting, as shown below.

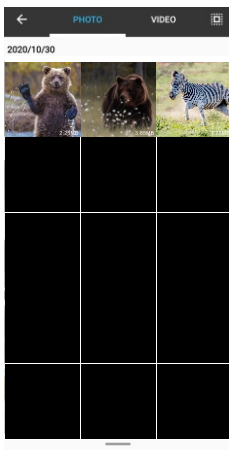

(2)

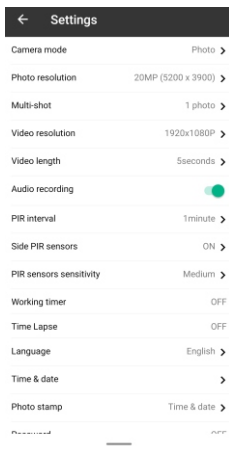

(3)

6. Install the Camera in the field

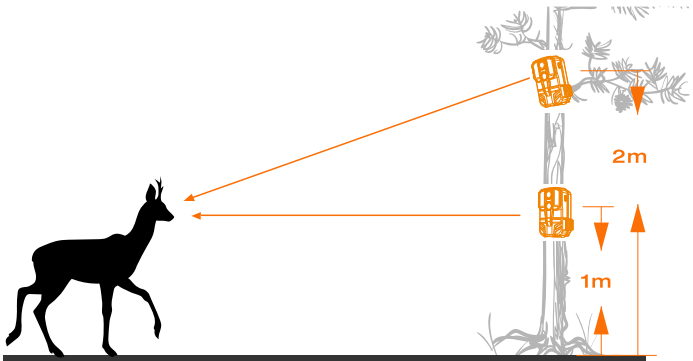

The SETUP mode is advantageous for determining the best detection angle and range of the movement sensor.

For this purpose, attach the camera at approx. 1m-2m height to a tree and align the camera to the desired direction.

At 1 meter height above the ground, place the camera parallel to the ground. At 2 meters height above the ground, tilt the camera down five degrees to the ground.

7. Enter ON / Live Mode

The standard application of the T90 Camera is the ON / Live mode. In this mode , photos will be taken when movement is detected.

To set up the ON / Live mode , switch power switch to ON position. The red LED will flash and the screen will count down 5 seconds when you just switch to Live mode (ON), then the camera work automatically and enters the ON / Live mode.

As soon as wild animals or other objects directly enter the detection area of the sensor zone, the camera starts to record photos and videos.

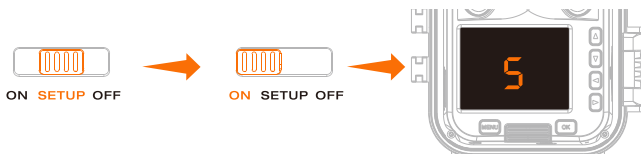

In the daytime, IR LEDs will not light up. The photos and videos are in color.

At night, IR LEDs will light up, and the photos and videos are in black and white.

The PIR Interval is 1 minute defaulted. The optional is 3s-60 min.

Please set up recording mode and related parameters before entering Live mode.

When Flash Light is set to "Auto", the camera will adjust the brightness of IR LEDs automatically in low power.

When shooting at night, the brightness will decrease automatically.

Under ultra low power, the power is not enough to light up the IR LEDs, shooting will stop at night.

8. TECHNICAL SPECIFICATION

Model	T90
Image Sensor	24MP CMOS sensor
Photo Resolution	24MP/20MP/16MP/12MP/8MP /5MP/3MP
Screen	2.4 inch LCD Screen
Storage	SD Card up to 128GB (NOT included)
Video Resolution	3840X2160P Lite, 2688X1520P, 1920X1080P, 1280X720P, 720PX480P
Night Vision Range	20 Meters (65 ft)
Detection Range	20 Meters (65 ft)
Trigger Time	Up to 0.2 second
Shot Interval	3 second ~ 59 minutes 59 seconds
IR LEDs	38 * 850nm IR LEDs
Detection Angle	120°
Media Format	AVI / JPG
Interface	Mini USB
Standby Time	Approx 6 Months (With 8 new battery)
Power Supply	8 x LR6 1.5V Alkaline battery External DC 6V / 2A

9. SIMPLE TROUBLE SHOOTING

EN

The camera will not turn on	<ol style="list-style-type: none">1. Please check whether the batteries are installed in proper way.2. Check if the battery capacity is low or exhausted. If so, please replace by new batteries.
The camera turns off automatically	<ol style="list-style-type: none">1. Please check whether the battery capacity is low or exhausted. If so, try to change new batteries for outdoor using or connect AC adapter for indoor using.2. Please check if SD card is full. If so, transfer images and videos to your computer or delete some files in the Replay Mode.
It shows "SD card Error"	<ol style="list-style-type: none">1. Please ensure that SD card is with class 10 standard or higher level.2. Please use the camera to format SD card at the first time.
Videos are choppy or jumpy when played on a computer	<ol style="list-style-type: none">1. Try to use different media players such as VLC player.2. Ensure AVI format Video clip can be played on your computer.
The image is not clear	<ol style="list-style-type: none">1. Please ensure that you have removed the protective films on IR LEDs and lens before using.
The camera does not take images or record videos	<ol style="list-style-type: none">1. Check if the memory of SD card is full, transfer images or videos to your computer or delete some files in the Replay Mode.

9.1 Care

Do not use any corrosive cleaners, such as methylated spirits, thinners, etc. to clean the camera and supplied accessory. When required, please use soft dry cloth to clean the camera.

9.2 Storage

If using batteries to power the camera and the camera is not being used for some time, please remove the batteries from the camera and store the battery separately in a dry place and out of the reach of children.

