



Imazing®



IM39

START YOUR ENGINE

ATTENTION

Do not attempt to place (or use) the equipment before you become familiar with the entire operating instructions. Keep the instructions for future use.

Failure to observe or inappropriate implementation of these instructions may cause personal injury or injury to others or may result in damage to equipment or workmanship. This device must not be used by children, people with reduced mental capabilities, or persons who do not have the skills, experience or knowledge of using it. Children must be kept under surveillance to not play with the device. The device is not intended for business purposes. Other uses or alterations to the device are for use other than for the intended purpose and pose serious hazards. The manufacturer is not liable for damages caused by any use other than use for the intended purpose.

The IM39 Jump starter is a device that serves as an emergency starting source for cars with 12V battery. There is a built-in battery with short-circuit protection, reverse polarity and overvoltage, which also enables the operation of a backup battery (power bank). The jump starter has an Emergency LED flashlight and has USB ports and USB-C Port ready to power the mobile electronics.

Before the first use of the device, User confirms with his free will that he has read the General safety instructions thoroughly, fully understood his meaning and familiarized himself with all the risks.

General Safety Instruction

- 1) This device must not be used by children
- 2) Danger of accidents and life threatening infants and children! Never leave children unattended with packaging material. There is danger of suffocation. Do not let children play with cables - risk of strangulation! Do not let children play with building and assembly parts, swallow them and suffocate, or people who do not have the skills
- 3) The manufacturer will not be held responsible for damages caused by:
 - Incorrect connection and / or use.
 - Impact of external forces, damage to equipment and / or damage to parts of the device by mechanical impact or load.
 - Any change made to the device.
 - Using the device for purposes other than those described in this manual.
 - Subsequent damage due to unspecified and / or inappropriate use and /or faulty accumulators.
 - Humidity and / or insufficient ventilation.
 - Unauthorized opening of the device. These causes the warranty to expire.
- 4) Danger of electric shock!
 - Ensure that the unit is always in a safe place. Do not allow the device to be exposed to dripping or dripping water or other liquids. When water penetrates into electrical equipment, there is an increased risk of electric shock.
 - Ensure that all plugs and cables are protected from moisture. Never connect the appliance to the power supply with wet or damp hands.
 - Do not touch the two connection terminals at the same time while operating the device.
 - Remove all cables from the battery before attempting to drive your vehicle.
 - Do not use a faulty device. Damaged device or charging cable increases the risk of electric shock.
 - Do not disassemble or repair the unit. Have the faulty device or damaged supply cable immediately repaired or replaced by a workshop.
 - Danger of short circuit! Make sure that the two charging cable terminals not touch each other when the device is plugged into an electrical outlet. Be careful not to connect the battery terminals or poles to conductive objects (eg tools).
 - Do not use the cord to carry or pull the device.
- 5) Danger of injury!
 - Do not use the device to start a car with a dry-cell battery. Such batteries may burst and injure the person present or cause material damage.
 - Always observe the instructions in the operating instructions and all safety warnings regarding the battery and vehicle being charged when using the unit.
 - Never use the device when it is dropped or otherwise damaged.
- 6) Use only 12 V vehicles for emergency launch. Use for vehicles with a different voltage would be dangerous. Prohibition of use for other devices such as aircraft, ships.
- 7) DO NOT use this unit if the cables and their terminals are damaged. DO NOT use instead of the vehicle battery. DO NOT use as the battery charger.
- 8) Never leave this unit connected to the battery after the engine has been successfully charged.
- 9) Only use the smart cables with clamps supplied with this unit for jump starting.
- 10) Make sure that the BLUE plug of the starter cable is fully inserted into the emergency start socket. Otherwise the blue plug would melt.
- 11) Ensure that all clean battery connections and battery terminals are securely connected before emergency starting. If the battery terminals of the vehicle are dirty or corroded, the current supplied from the unit will be reduced.
- 12) DO NOT RUN more than three starts in a row behind you. The unit could be damaged by overheating. Wait two minutes before trying again. The emergency charging cable may overheat and disconnect as a safety precaution.
- 13) Disconnect the unit from the vehicle's battery within 30 seconds after the emergency start. Otherwise, it could be damaged.
- 14) DO NOT use as a toy.
- 15) Let the equipment NOT be used by young and inexperienced people without supervision.
- 16) DO NOT allow the product to soak.
- 17) DO NOT place the product in water.
- 18) DO NOT use the product in an explosive atmosphere, eg in the presence of flammable liquids gases or dust.
- 19) DO NOT REMOVE AND DO NOT disassemble the unit. Repairs to this unit may only be performed by a supplier / authorised service technician.
- 20) DO NOT expose the unit to extreme heat or fire.
- 21) Ensure that someone is always in the hearing or so close to working with batteries to help you.
- 22) When working with this unit, remove personal metal objects such as rings, bracelets, necklaces, etc.
- 23) DO NOT allow this unit to fall. If the unit is severely damaged or otherwise damaged, have it checked by a qualified technician.
- 24) DO NOT place the unit in places where the temperature may exceed 70 °C.
- 25) Charge only at ambient temperatures in the range of 0°C to 60 °C.
- 26) Charge only with the charger supplied with this unit.
- 27) DO NOT use this unit to start the emergency vehicle when charging the internal battery.
- 28) If liquid leaks from the unit, dispose of it immediately at the appropriate recycling facility.
- 29) Under extreme conditions, liquid may escape. If liquid comes out of the unit, do not touch the unit with bare hands. Immediately wash off contaminated skin with soap and water. In case of eye contact, rinse eyes with cool running water for at least 10 minutes and seek immediate medical attention.
- 30) The product contains a lithium battery. At the end of battery life, discard the product in accordance with local regulations.

HOW TO USE THE JUMP STARTER



Check the level of battery of jump starter. New jump starter must be charged before usage.

1. Connect the starter cable with the battery clamps to the jump starter with the blue connector (4). After the connection is successful, the blue indicator on the cable is on.
NOTICE: Additional smart cable light display options are described in the "Smart cable light display" chapter.
2. Connect the red clamp to the positive pole (+) and the black clamp to the negative terminal (-) of the battery.
3. Start the vehicle.
4. Disconnect the clamps from the battery.
5. Disconnect the start-up cable from the jump starter.

NOTICE!

You must disconnect the jump starter within 30 seconds after starting, otherwise it may be damaged. If the vehicle does not start within 6 seconds since starting of vehicle, let the jump starter cool down for 2 minutes before starting again. Do not exceed 4 attempts to start. If the start fails, the car battery is probably defective or the starter station does not have enough power to start the vehicle.

THE F19 CLAMP

Smart Jumper Cable Normal/Abnormal Display Status

Light Display	Buzzer Warning	Explanation	Reason/Solution
	/	Ready Mode	After the clamp cable is inserted into the jump starter, it can be used normally.
	/	Normal operation condition	Clamp cable correctly connected to load/clamp cable conduction work
	Buzzer is Long Bleep	Over-limit Protection	Jump starter voltage is low. Use bigger capacity of jump starter.
	Buzzer is Long Bleep	Over Crank Attempt Protection	Disconnect smart jumper cable from jump starter and vehicle battery, then re-connect appropriately.
	Buzzer is Long Bleep	Relay Connection Faulty Protection	Smart jumper cable is damaged, stop using it and carefully store in a safe place.
	Buzzer is Long Bleep	Low Voltage Protection 14.0±0.5V	The jump starter voltage is low. Charge the jump starter at least more than 25%.
	Buzzer is Long Bleep	Reverse Polarity Protection	Reverse the battery connections. Ensure that the jumper clamps are connected correctly to the vehicle battery terminals.
	Buzzer is Long Bleep	Short Circuit Protection	Cables aren't connected properly. Disconnect all connections and try to connect again properly.
	Buzzer is Long Bleep	Reverse Charging Protection	Disconnect the jump starter within 30 seconds after successfully jump start.
	Buzzer is Long Bleep	Jump Starter Overheat Protection	The jump starter internal battery is too hot. Allow the jump starter to cool in a cooler environment.
	Buzzer is Long Bleep	Over-Voltage Protection 18.0±0.5V	Jump starter is over voltage or damaged. Stop using it and carefully store in a safe place.
Display view 			



IMAZING IM39 User guide

3

TECHNICAL SPECIFICATIONS



Capacity	99.2 Wh
Dimensions	225 x 98 x 46mm
Start Current	2000 A
Peak Current	4000 A
Output/Input	USB Type-C 3A
Output USB1	5V/3A 9V/2A 12V/1.5A
Output USB2	5V/2.4 A
Output DC	12.5V~17V/12A
Usage Temperature	-10°C till 55°C
LED Light	Light, SOS

IMAZING IM39 User guide

5

IMAZING IM39 User guide

4

CHARGING VIA USB

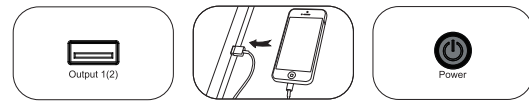

1. Plug the power cord into the USB Output
2. Press power

TYPE C OUTPUT / INPUT

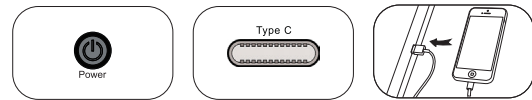

1. Press power
2. USB Type-C output to charge your electronic device.
3. USB Type-C input to charge the unit. (USB adapter not included.) It is charging when the power indicator lighting and flashing.

DC OUTPUT

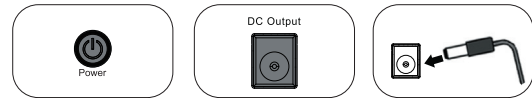

1. Press power
2. Plug the DC Output Cord

USING LED FLASHLIGHT

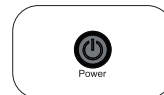

1. Hold the Power button for 3 seconds, then press briefly to change the light mode (Flashlight, SOS, Strobe).

IMAZING IM39 User guide

6