

KINVOCA

User Manual

For Joy-Pad Controller

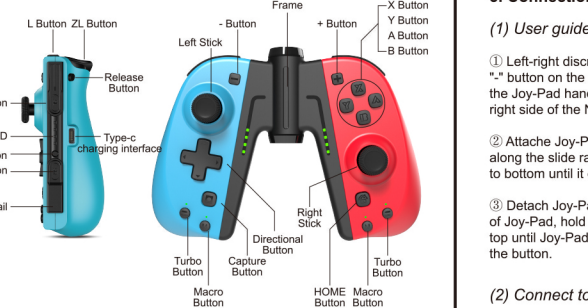

1. Product description

Joy-Pad Wireless Bluetooth is the standard controller for Nintendo Switch. It can be connected to the host screen via the rail and can also be used wirelessly without the rail. It has the functions of the normal controller. In some specific games, a single Joy-Pad can be used horizontally like the joystick, and in some games, the two Joy-Pad can be grabbed by hands like a somatosensory joystick. Joy-Pad is equipped with a motor vibration and 6 axis function, no NFC function, no infrared camera, does not support live upgrade, only a local upgrade package.

2. Product Parameters

- (1) Joy-Pad size: 105 * 48 * 48mm (a single)
- (2) Weight of Joy-Pad: 68 ± 5g (a single)
- (3) Material: New ABS material
- (4) Connection Method: Bluetooth
- (5) Input Voltage and Current: DC 4.5 ~ 5.5V 400mA
- (6) Battery Capacity: 300mh Charging time: 2H Usage time: 8H
- (7) Vibration: Each Joy-Pad handles with a motor, a powerful vibration mode
- (8) Built-in: 6-axis gyroscope and acceleration function for the better gaming experience
- (9) TURBO function: Supports burst function and erase burst function

3. Connection Method

(1) User guide

- ① Left-right discrimination: Joy-Pad faces up, the Joy-Pad handle with the "+" button on the upper right is installed on the left side of the NS host, and the Joy-Pad handle with the "+" button on the upper left is installed on the right side of the NS host.
- ② Attache Joy-Pad to the NS host: The side with the "+" and "-" button up, along the slide rails on both sides of the host screen, slide Joy-Pad from top to bottom until it clicks, indicating successful installation.
- ③ Detach Joy-Pad on the device: Find the release button on the upper back of Joy-Pad, hold down the release button and slide Joy-Pad from bottom to top until Joy-Pad is completely detached from the device, and then release the button.

(2) Connect to use

- ① First connection
Method 1: Install the two Joy-Pad on the rails on both sides of the host screen respectively. Slide the Joy-Pad up and down until it clicks. The host will have an icon to indicate that the connection is successful. After a successful connection, you can detach the Joy-Pad to use, and the Joy-Pad will automatically connect to the host. Note: A host can connect up to 6 control devices, and a Joy-Pad is equivalent to one control device.
Method 2: 1. Press the host power button to enter the host interface 2. Do the following: "Controllers-" Change Grip / Order ", after accessing this interface, press the SYNC button on both Joy-Pad for more than 2 seconds to connect, at this time, the 4 LEDs will flash like a marquee. Once the connection is successful, the corresponding Player LED indicator is always on. then press the L + R button to use it.
- ② Log in again

Method 1: When Joy-Pad is installed in the slide rails of the host screen, press the HOME button on Joy-Pad can directly wake up the host.
Method 2: When Joy-Pad and the host are separated, press the power button on the host to enter the host interface, keep the screen always on, and then long-press the capture button and the HOME button for 1-2 seconds to wake up the two Joy-Pad, the 4 LEDs flash quickly to connect to the host.

(3) The Reset function

When the Joy-Pad has some insolvable faults, you can try to press the reset button on the back of Joy-Pad and keep it pressed for more than 5 seconds until the handle is powered off and reset. if you want to reconnect again, please refer to the method of connecting the Joy-Pad for the first time.

(4) Automatic sleep mode

When Joy-Pad is installed on the host, the Joy-Pad will automatically into sleep mode if the host screen turns off, you can press the HOME button to wake up the host. When Joy-Pad and the host are separated, Joy-Pad will stop sleep automatically if there is no operation within 5 minutes.

(5) Charging instructions

When the Joy-Pad's battery is low, the main screen will prompt to charge, there are three ways to quickly recharge it:

- ① You can install the Joy-Pad on the host to charge. The battery logo on the main screen will display green, and it will turn to black when fully charged.
- ② Charged the handle with the data cable. The 4 LED indicators flash slowly, and it will go off when fully charged.

Note: Please use the provided data cable for charge, which will protect the switch controller from the damage of fast charge (The parameter of the charging plug should be 5V1A)

(6) TURBO Function

- ① Set the TURBO function: Press A/B/X/Y/L/R/ZL/ZR, then press the TURBO button.
- ② Clear the TURBO function: Press A/B/X/Y/L/R/ZL/ZR again, and then press the TURBO button.

Note : When you press the button with the TURBO function, there is a light indication. The corresponding TURBO button function can only be set on the corresponding Joy-Pad.

(7) Macro function

① Macro function setting: When the Joy-Pad is running, long-press the "Macro" button for 3 seconds until the LED flashes slowly, release the "Macro" button to enter definition mode, and then press the buttons to be set, then press the "Macro" button again to save the setting. At this time, the definition of the macro will record the sequence of presses on each button. Note: The function of the corresponding "Macro" button can only be configured on the corresponding Joy-Pad. This function is mainly used in fighting games. For example, when you want to send large movements, you have to press several buttons in order. As long as these buttons are defined using the macro function, you can release the big movement with one button.

② Erase the Macro function: Under the operating state of the Joy-Pad, press and hold the "Macro" button until the LED flashes rapidly 3 times, you can erase the current Macro function.

(8) Calibration

When used for the first time, please calibrated the joystick and the gyro sensor after connecting the host.

(9) Joy-Pad Frame

After installed the two Joy-Pad on the frame, it can be used as a pro controller, you can still feel relaxed and happy after play on TV or desktop mode for a long time.

(10) About the upgrade

The Joy-Pad can be upgraded without a driver (on PC) via our equipped data cable, the upgrade platform supports Win XP / Win7 / Win8.1 / Win10, does not support the Apple ios system upgrade.

(11) Attention:

Our products do not have the NFC function, and the Joy-Pad is not equipped with an infrared camera, so it's not suitable for games that require such functions. The integrated engine is not a high definition engine, in some games, the vibration experience may be different. Our products are compatible with Nintendo Switch and Switch Lite, it can be used to replace the original Joy-Pad, but they are not suitable for any accessory corresponding to the original Joy-Pad.

4. FAQ

(1) How to distinguish the Joy-Pad is on the left or on the right ?

The Joy-Pad on the left has a "+" button at the top right, and the Joy-Pad on the right has a "+" button at the top left.



(2) How to connect the Joy-Pad to the switch host for the first time?

Method 1:
Slide the two Joy-Pad from top to bottom on the rails of the host screen, until you hear a click.

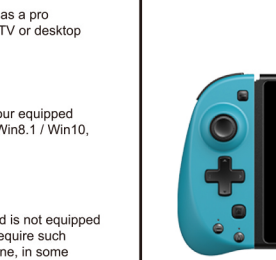

Method 2:
Step 1: Press the host power button to access the host interface, click on "Controllers"



Step 2: Click on "Change Grip/Order"

(3) How to detach the Joy-Pad from the host?

Press and hold the release button on the back of the Joy-Pad, then slide it down to remove it.
※ When the Joy-Pad detaches from the host, the host correspondence information will be retained and can be used directly as a wireless controller. When the power is low, it can be installed on the charging host to charge.

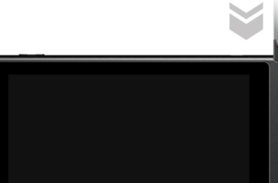

(4) How to install/remove the Joy-Pad from the frame?

How to install: Remove the Joy-Pad from the host and slide it from the rails on the left and right sides of the frame from top to bottom until you hear a "click".

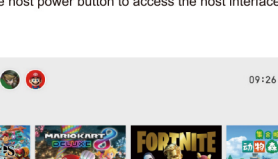

How to detach:

Press and hold the release button on the back of the Joy-Pad and slide the Joy-Pad from bottom to top.

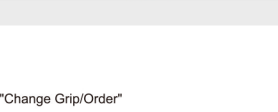

(5) How to do if the buttons on the Joy-Pad malfunction or do not work?

Please do the following test: System Settings - Controllers and Sensors - Test Input Devices - Test controller Buttons (If there are any issues with the button in testing, please contact Customer Service for a replacement).

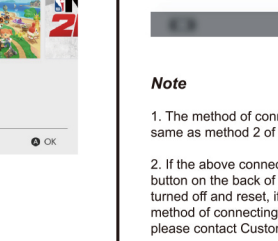

(6) How to do if the right and the left stick have some problems ?

Please perform a stick calibration: System Settings - Controllers and Sensors - Calibrate Control Sticks

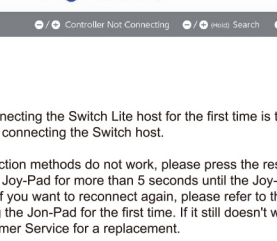
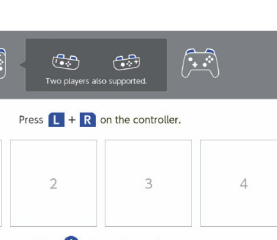
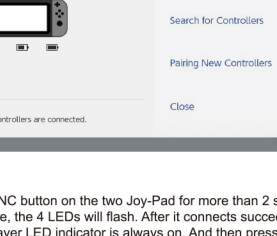

(7) How can you do if there are problems with the Joy-Pad's gyro sensor?

Please calibrate gyroscopes: System Settings - Controllers and Sensors - Calibrate Motion Controls - Calibrate Controllers (Please note that the joystick must be placed horizontally during the correction).

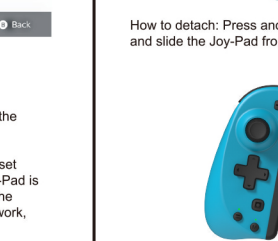
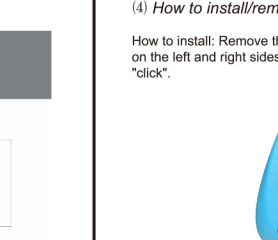
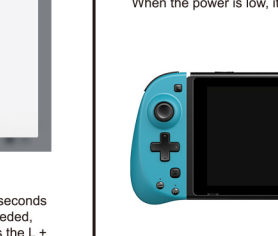

Note

1. The method of connecting the Switch Lite host for the first time is the same as method 2 of connecting the Switch host.
2. If the above connection methods do not work, please press the reset button on the back of Joy-Pad for more than 5 seconds until the Joy-Pad is turned off and reset, if you want to reconnect again, please refer to the method of connecting the Joy-Pad for the first time. If it still doesn't work, please contact Customer Service for a replacement.