

快速入門指南

1

砭石理療頭安裝方法

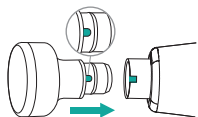

★凸槽對準主機的凹槽用力推到位
請不要旋轉理療頭

2

其它理療頭安裝方法

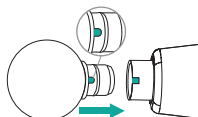

★凸槽對準主機的凹槽用力推到位
請不要旋轉理療頭

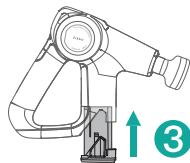

電池安裝方法 ★電池的凸槽對準主機的凹槽用力推到位

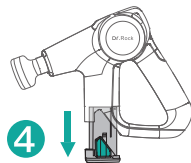

電池拆卸方法 ★按住電池的拆卸鍵
垂直用力拔出電池

注意

- 1、砭石溫敷理療頭和其他理療頭都有安裝限位，對準後插入；
- 2、電池的拆卸注意，不可旋轉，按下拆卸按鈕，直接垂直插拔即可。

5

控制面板與充電口

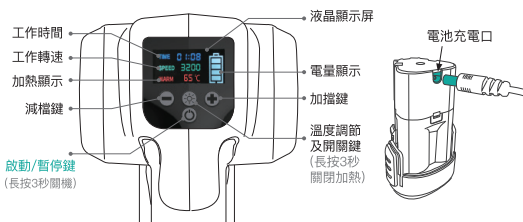

6

砭石加熱功能

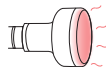

打開溫敷開關，等待3分鐘，
砭石溫敷頭溫度
可達40攝氏度至65攝氏度。

請掃描更多資訊



Quick start guide

1

Bian Stone warm compress
head installation method

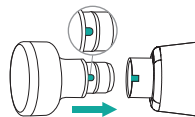

★ The bump is aligned with the groove
of the host and pushed firmly into place.
Please do not rotate the Bian Stone head

2

Other physical therapy head
installation methods



★ The bump is aligned with the groove
of the host and pushed firmly into place.
Please do not rotate the Bian Stone head

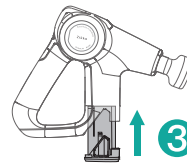

電池安裝方法
★ The bump of the battery is pushed into
place with the groove of the host

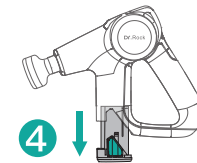

電池拆卸方法
★ Press the battery release button and pull
out the battery forcefully and vertically

Note

1. Bian Stone head and other heads have mounting limits, which are inserted after being aligned;
2. Unloading the battery can not be rotated, press the unload button and directly insert and remove

5

Control panel and charging port

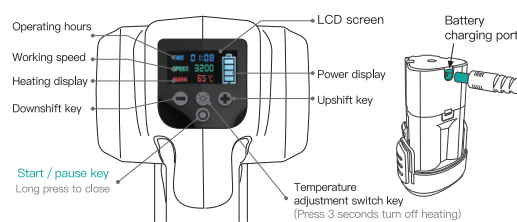

6

Bian stone heating function

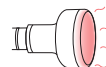

Turn on the warming switch and wait
for 3 minutes. The temperature of the
Bian stone can reach 40 to 65 degrees.

Scan a QR Code

