

**HYPERLITE**  
www.hi-hyperlite.com

A good & brand new product. Congrats!  
Enjoy brighter life now.

Feel free to contact us  
Email: [service01@hi-hyperlite.com](mailto:service01@hi-hyperlite.com)  
Toll-free number: +1(855) 688 7879

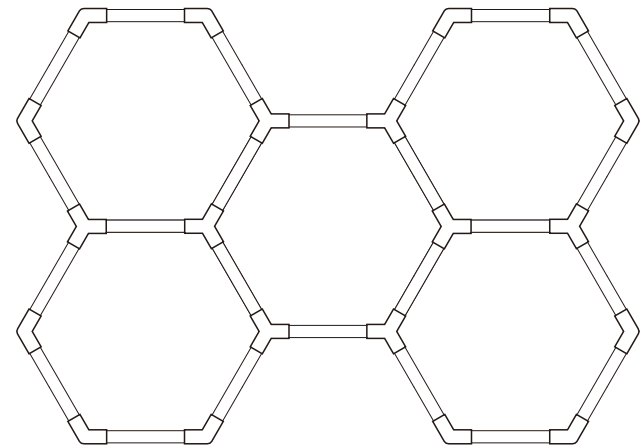

**HONEYCOMB SERIES**

HEXAGON LED LIGHT

RELIABLE SOLID BRIGHT

# HEXAGON LED LIGHT HONEYCOMB Series

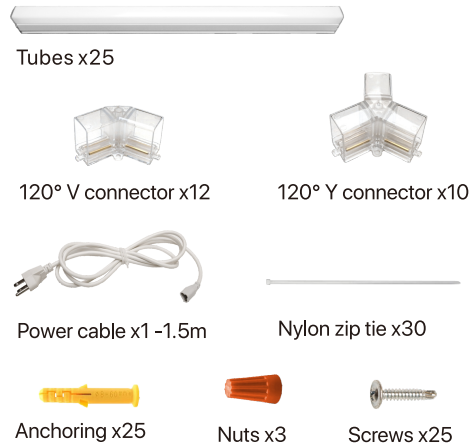
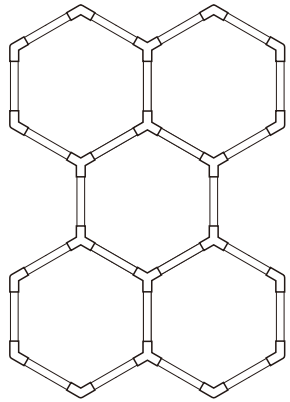

## FEATURES & SPECIFICATIONS

Performance Data		Honeycomb
General	Efficacy	110 lm/W
	CCT	5000K / 6500K
	CRI	>80
	Life span	>30,000 hours
	Color	White
Electrical	Power	144W
	Input voltage	AC 120V
	Current	1.2A
	Power factor	>0.9
Physical & Listing	Mounting	Suspension / Surface mount
	Warranty	24 Months

## PACKAGING INFORMATION

Model	Wattage	Qty/Ctn	Net Weight	Gross Weight	CTN Size
HB-HC-5HEX-50/65	144W	1	6.6 ± 1 lbs	8.2 ± 1 lbs	18.9" * 11.8" * 5.9"

## INSTALLATION

- Connect the tubes by series as follows, each red circles requires its own power source.

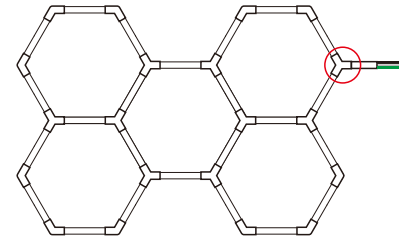

**CAUTION!!**  
 1. Please be careful when connecting the light bars with the connectors. Don't damage the copper needle in the connectors.  
 2. TEST BEFORE INSTALLING TO THE CEILING.  
 3. Only 1 connector for AC input cord:  
 Black-L  
 White-N  
 Green-G

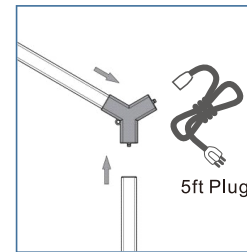

1. Confirm the correct AC input connector

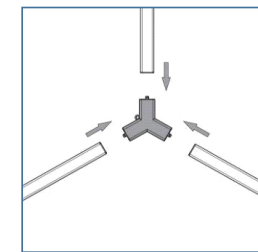

2. Connect the 120° Y connector

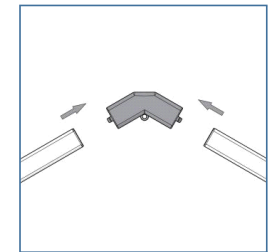

3. Connect the 120° V connector

- How to install it on the ceiling.

1. Grid roof - Tie it with zip ties

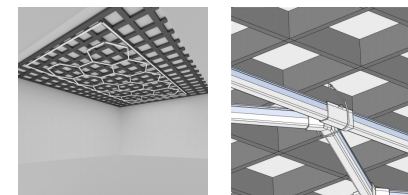

2. Flat roof - Screw the connector from the hole to the ceiling directly

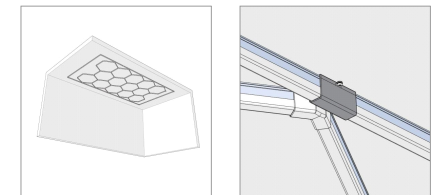

Remarks:

1. There should be 1 wire out to connect with 120V;
2. Please install by professional electrician;

**⚠ WARNING**  
 Please do not match the connectors by violence, it would damage the whole set of lamps. If it does not match the lamps well, please try to joint accurately or change the lamp, do not damage the connectors by violence. Test by AVO meter before powering on.

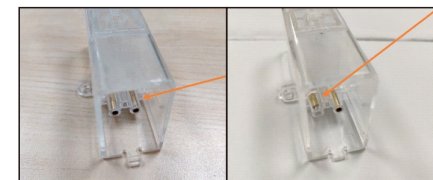

The well made copper parts      ! The deformed copper parts by violence